

 INSTALLATION GUIDE

OBEX  **CORTEX^{FR}**

0100FR

DPC

Membrane

Class B

Version 01.01.01

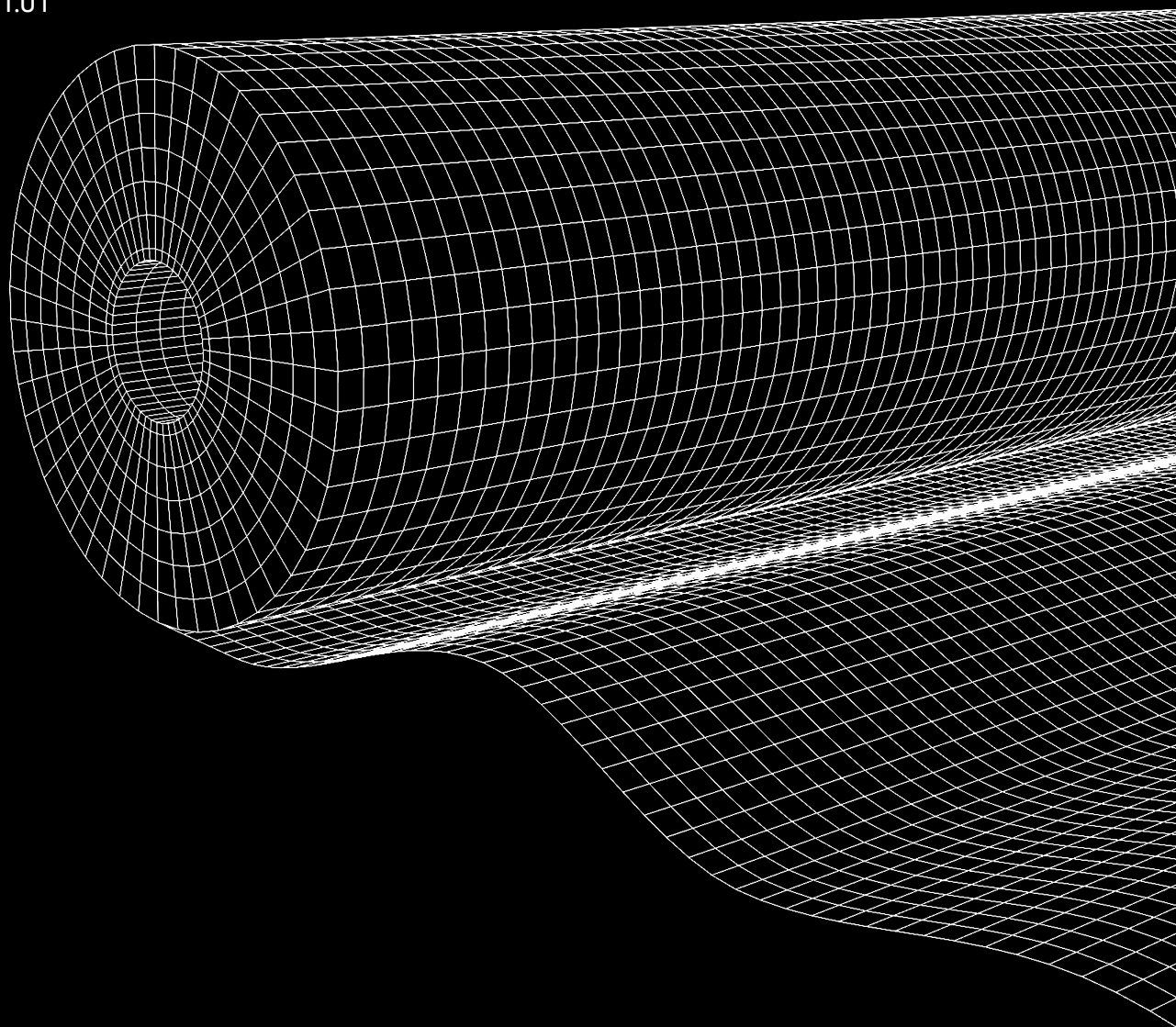

 **OBEX[®]**

Contents

Standard Installation 03

Important Notes

- » Firmly roll the membrane into the paste to ensure full bond strength is achieved.
- » The rolls may invariably contain joins. These should be overlapped and bonded by a minimum of 50mm.
- » Horizontal membranes must lap under vertical membranes by a minimum of 50mm.
- » Make sure the membrane hangs over the sides of the cavity barrier by 25mm on both sides.

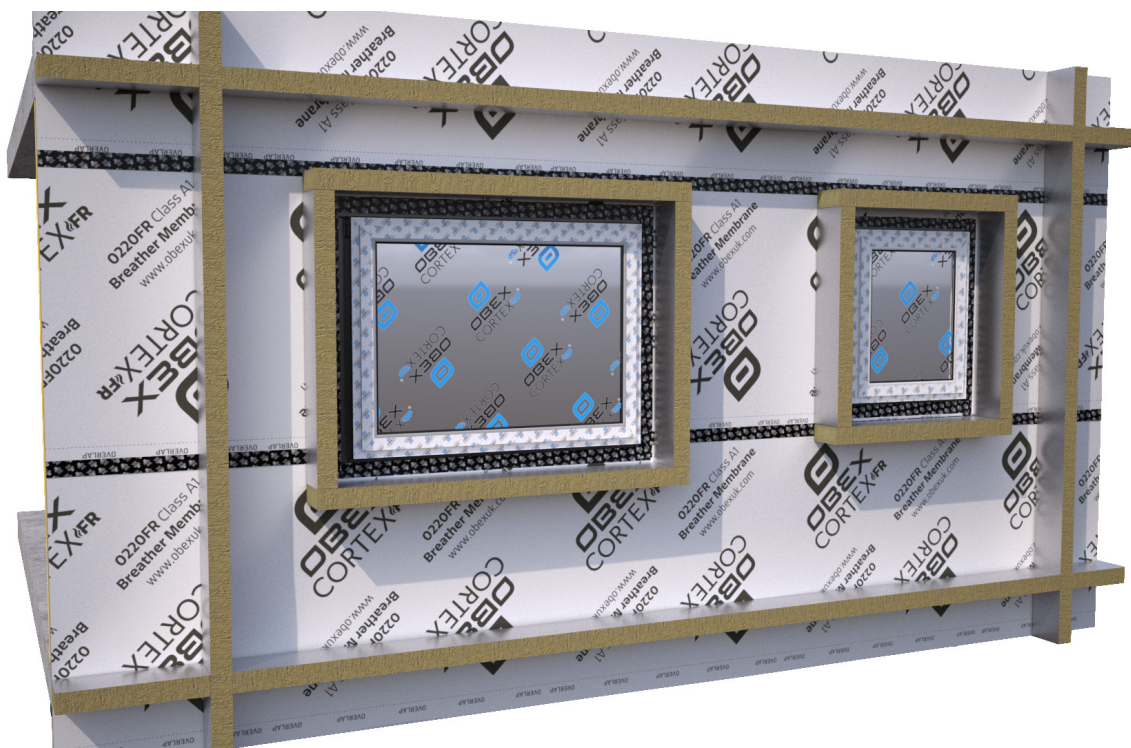

1

Install cavity barriers as per manufacturers instructions.



2

Apply a bead of OBEX CORTEX 0771FR paste adhesive to the outward face of the cavity barrier. Start with the horizontal cavity barriers.

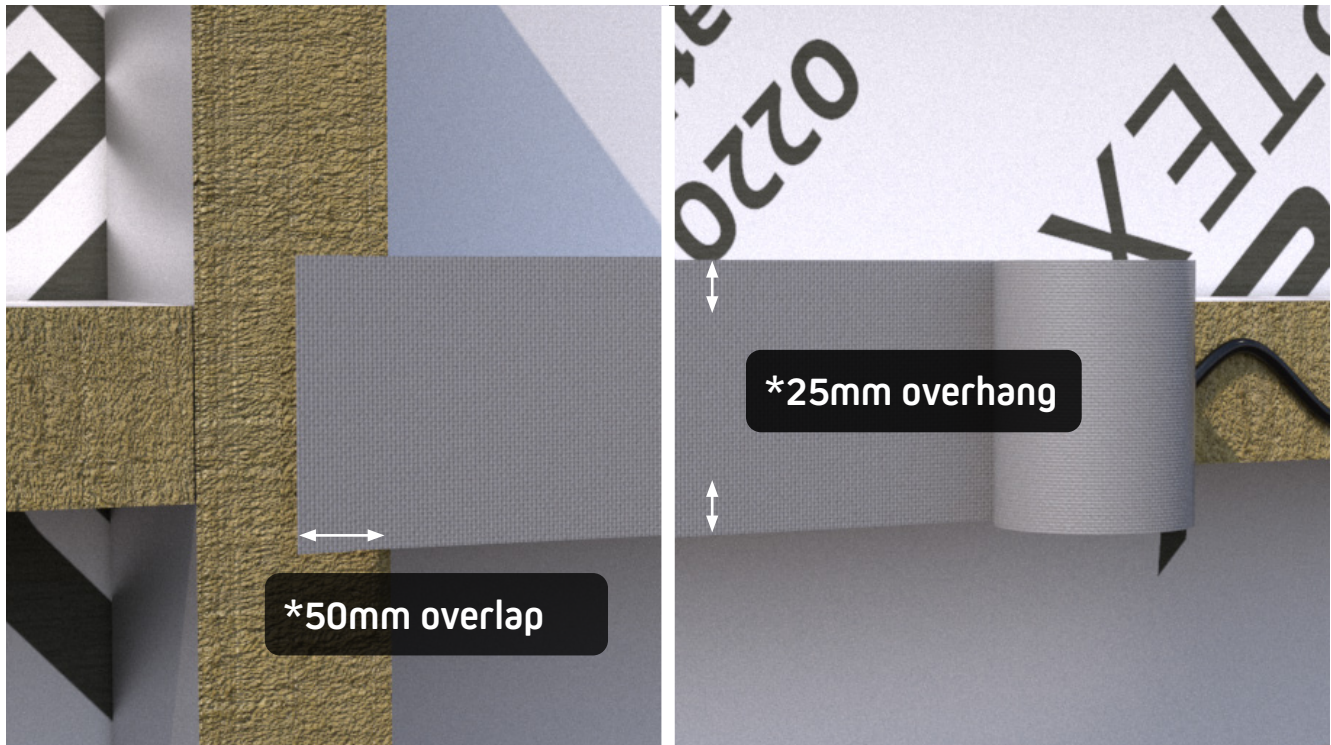

3

Roll out the OBEX CORTEX 0100FR DPC Membrane, ensuring the membrane overlaps the vertical cavity barrier by at least 50mm, also make sure the roll is wide enough to overhang the barrier by 25mm on both side.

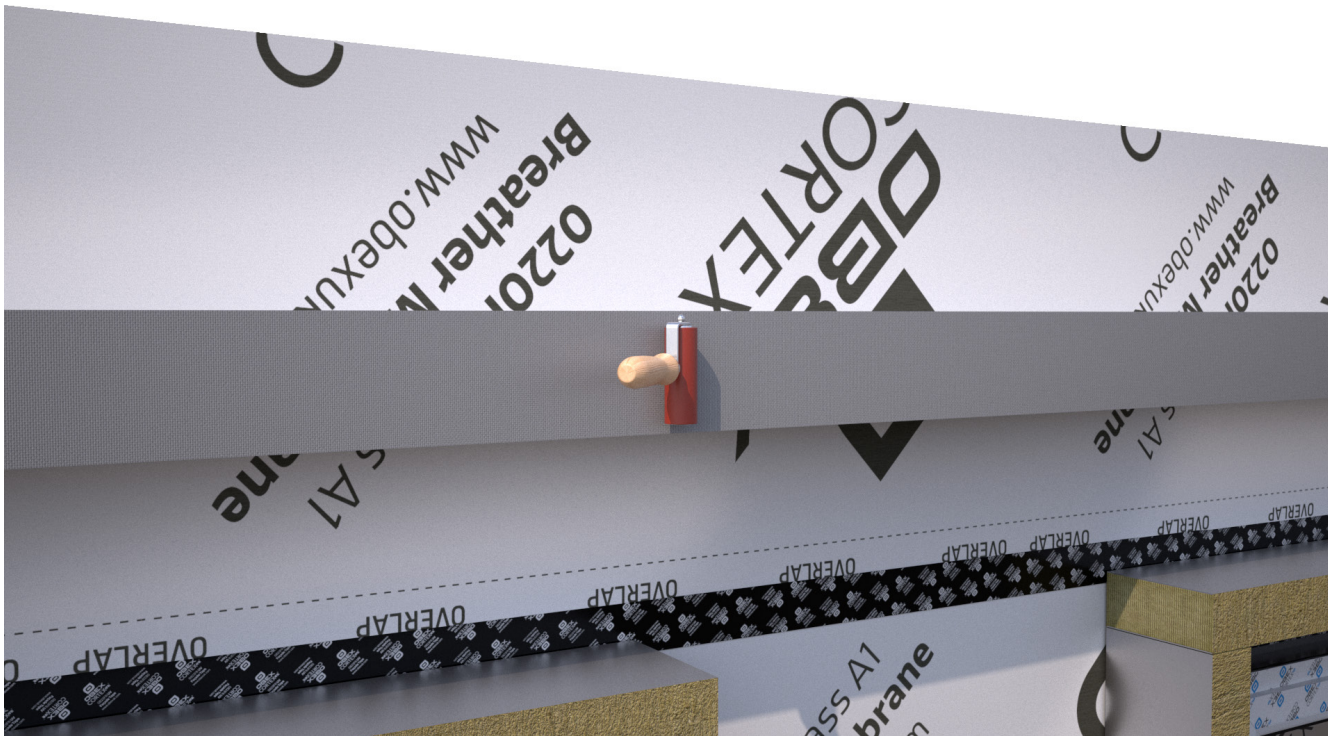

4

Firmly roll over the membrane with a rubber roller, ensuring to cover the full width of the cavity barrier below.

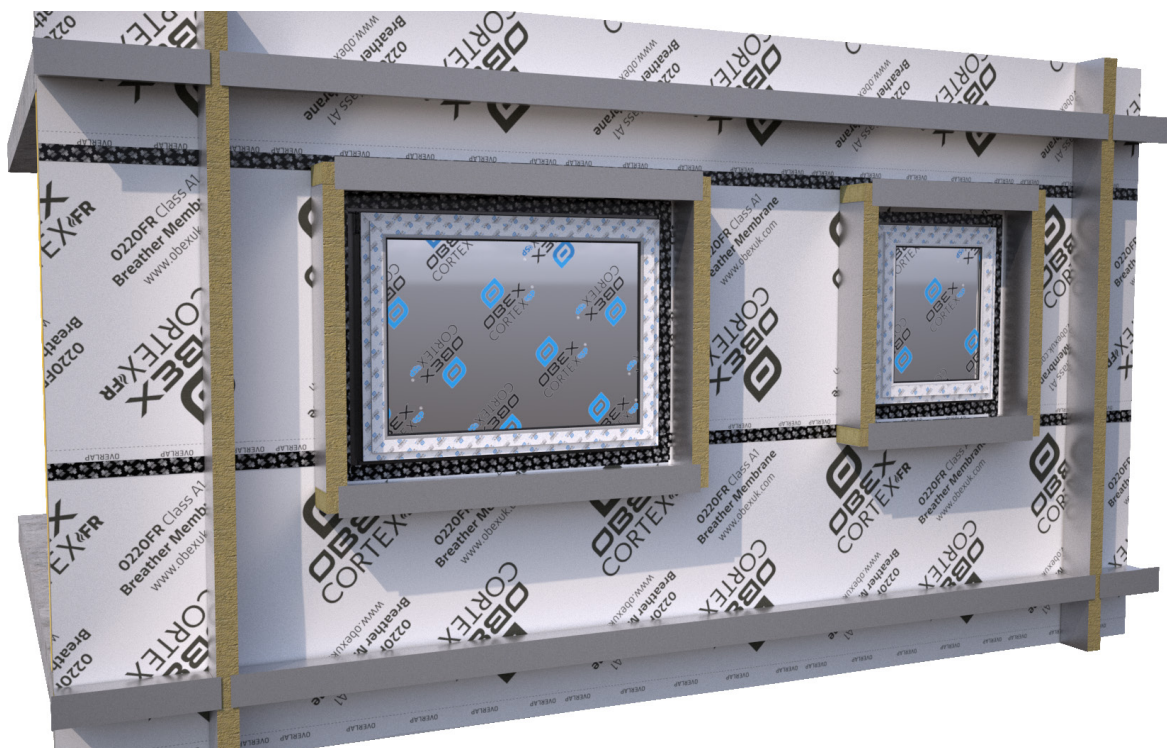

5

Complete all horizontal faces, and ensure that all membranes overlap the vertical cavity barriers by 50mm.



6

Next start on the verticals by applying OBEX CORTEX 0771FR as per previous instructions.

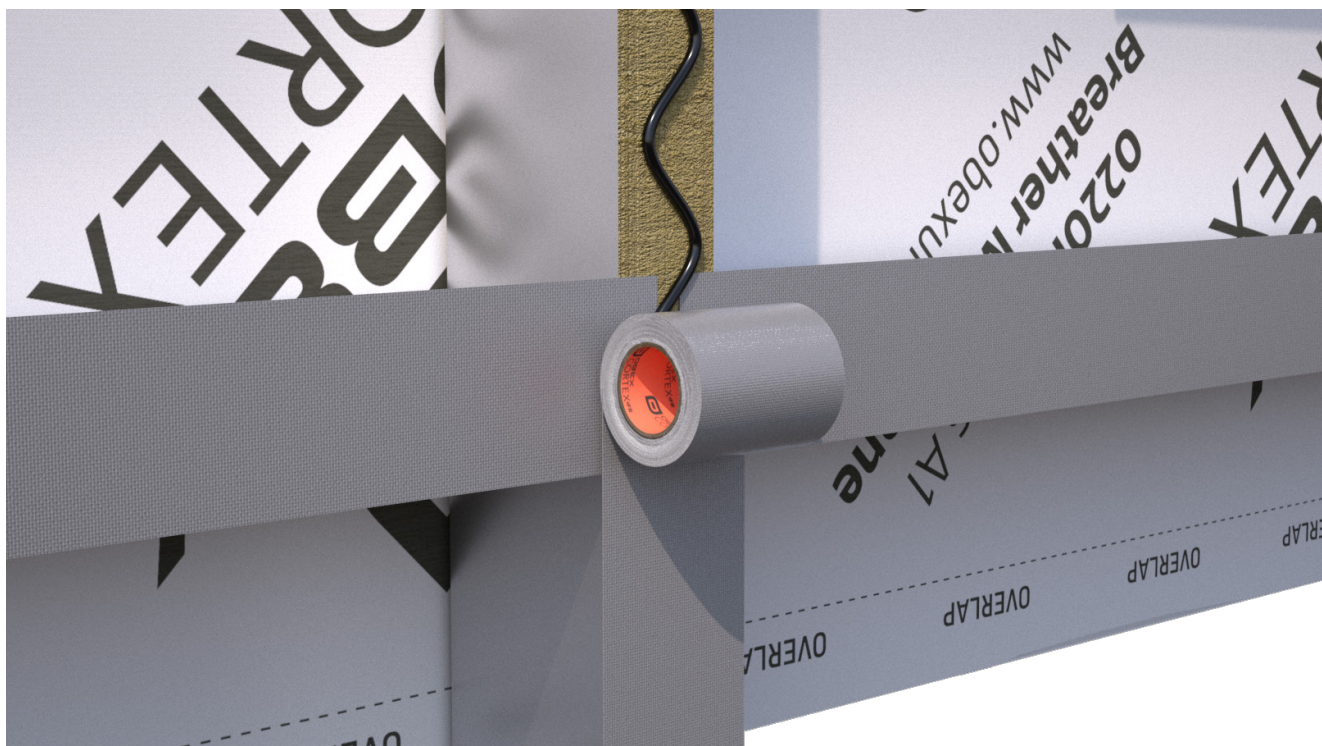

7

Roll out another length of 0100FR to cover the vertical cavity barrier, ensuring to overlap any horizontal sections.



8

Firmly roll over the membrane with a rubber roller, ensuring to cover the full width of the cavity barrier below.

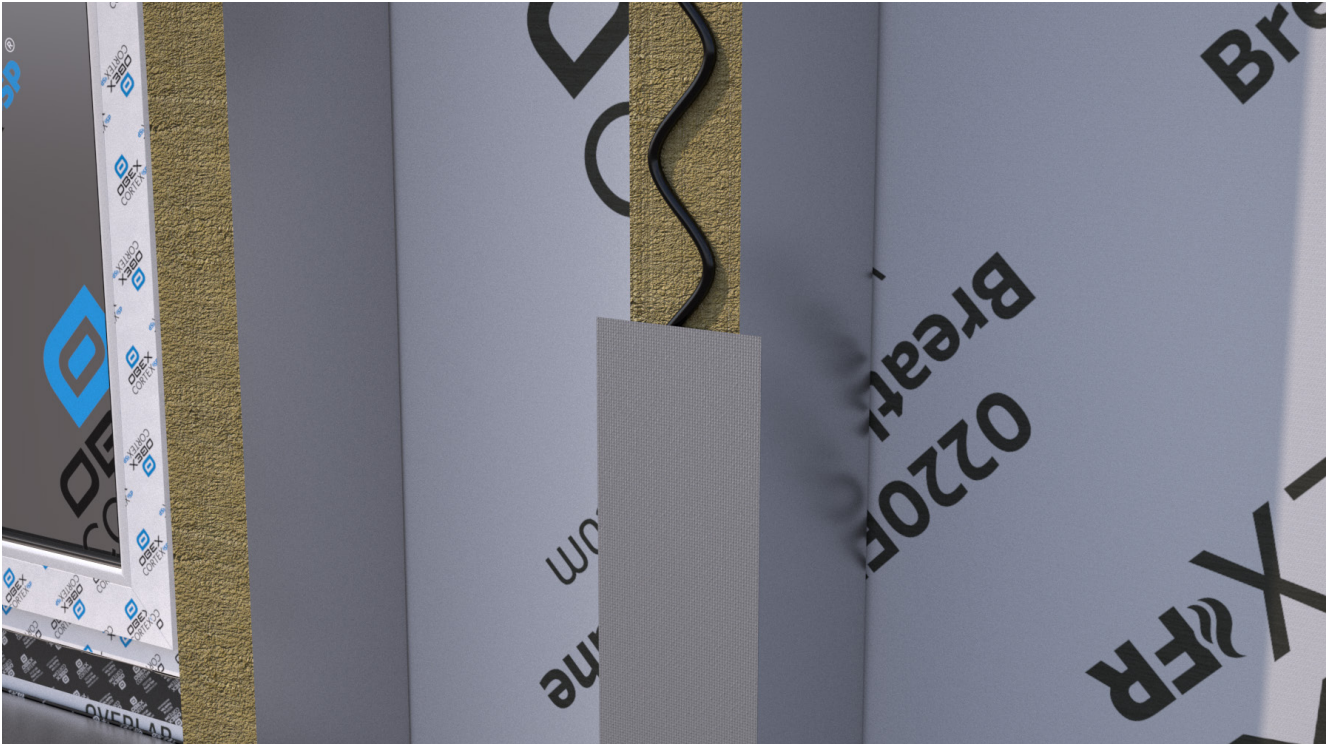

9

If covering a barrier longer than the remaining membrane on the roll, apply the paste and remaining membrane as per the previous steps then continue to the next step for overlapping guides.

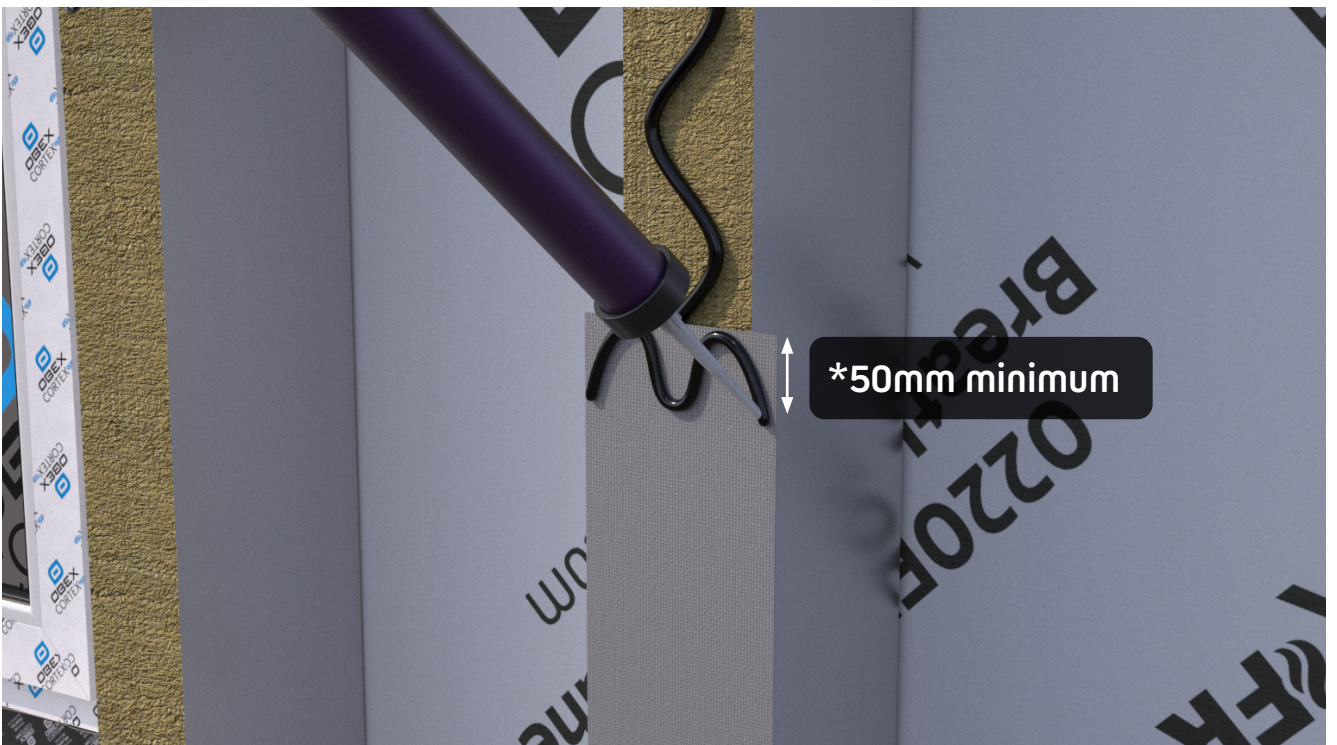

10

Apply paste to at least 50mm below the joint.

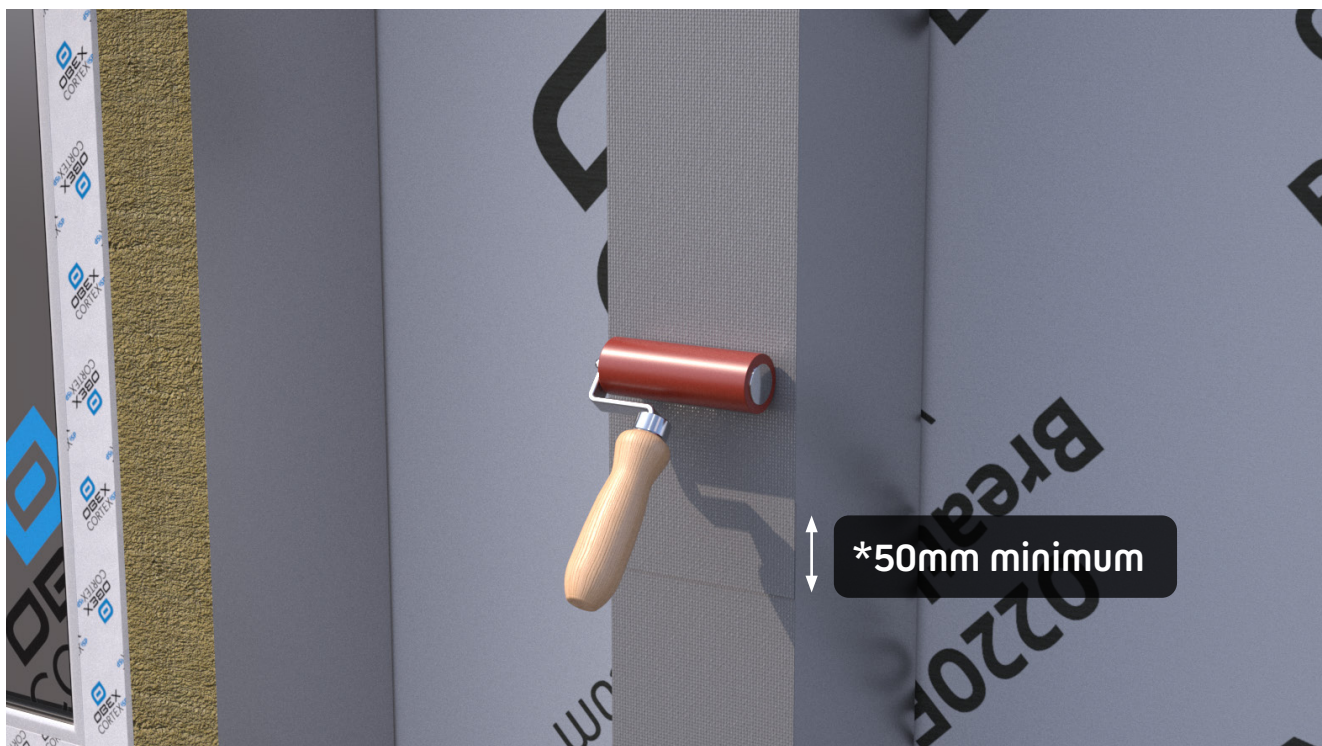

11

Roll out another length of 0100FR from the new roll, and overhang the lower membrane by 50mm. Apply firm pressure with a rubber roller to ensure maximum adhesion.

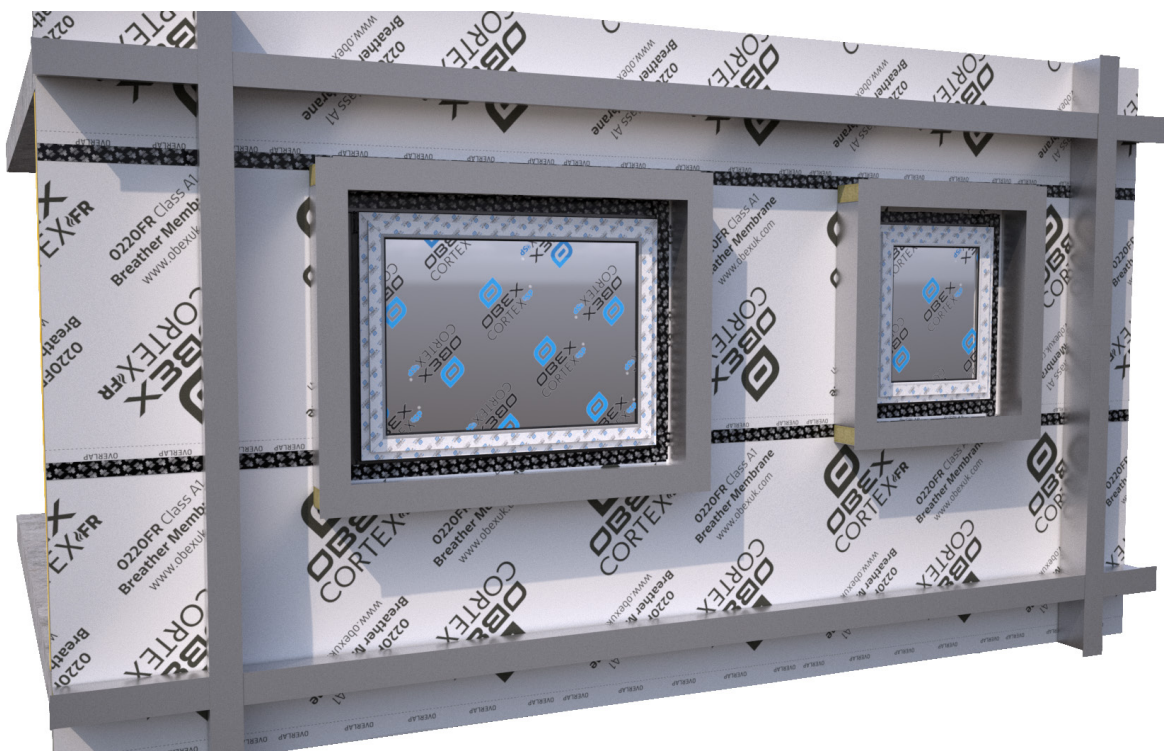

12

Continue to complete all vertical sections.

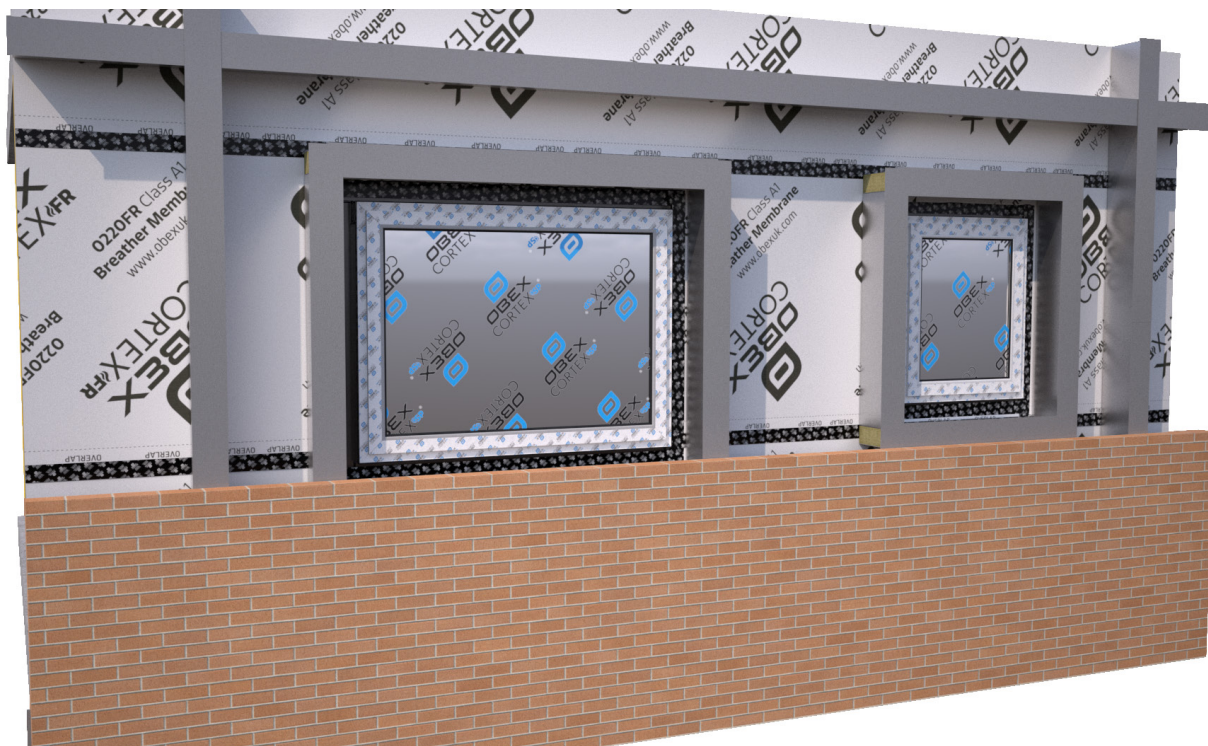

13

This is how the wall should look as the brickwork is built up.



OBEX Protection Ltd. Unit 5 Indurent Park, Norton Road, Broomhall, Worcester, WR5 2QR

Call: +44 (0) 1905 337800 | **Email:** sales@obexuk.com | **Visit:** www.obexglobal.com/uk

© Copyright 2022 OBEX. All rights reserved. Company Registration No. 09157067, VAT No: 868 7649 48