

 INSTALLATION GUIDE

OBEX  **CORTEX^{FR}**

0531FR

Vapour & Air Tape

Class B

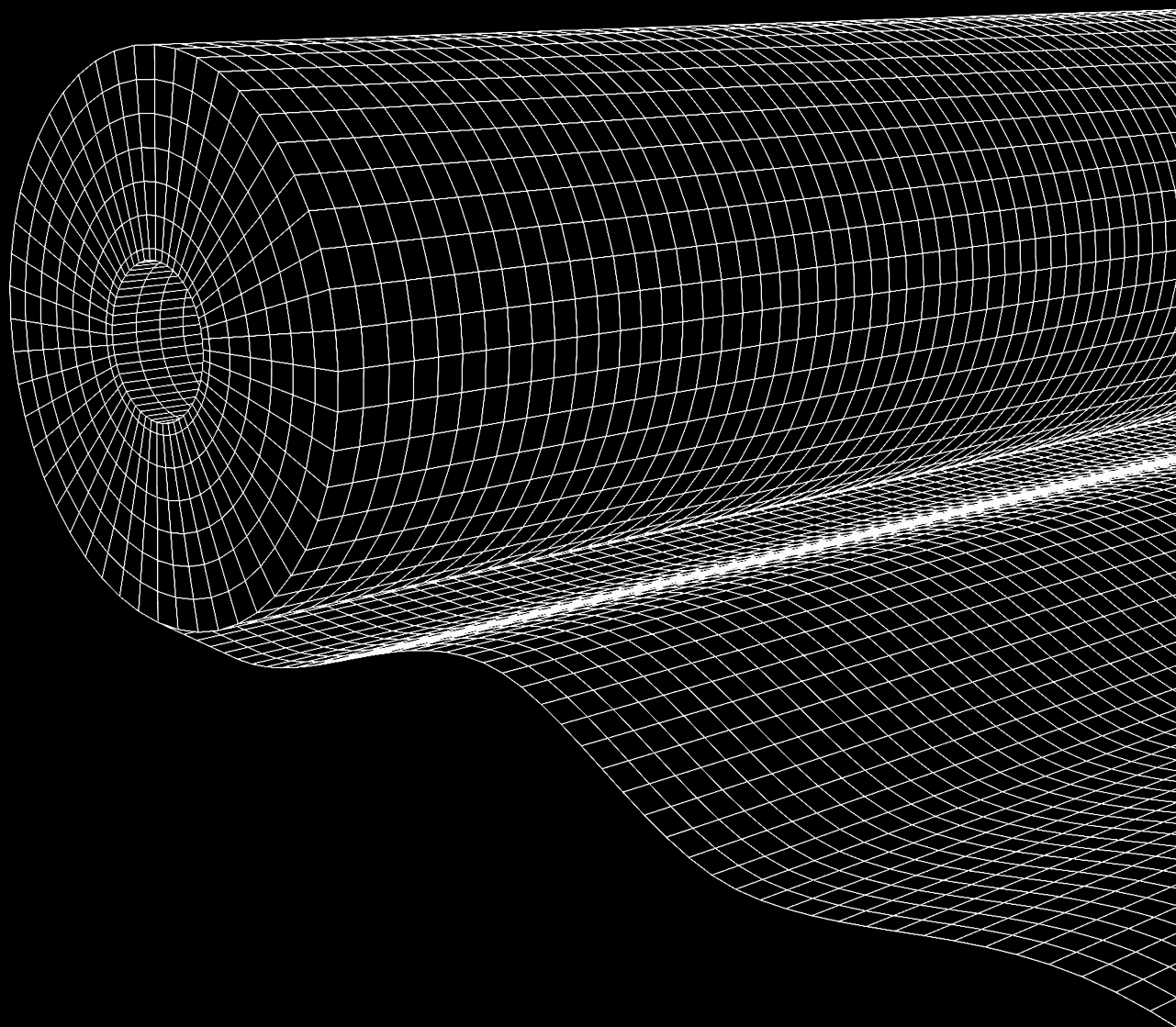

 **OBEX[®]**

VERSION: 02.01.01

Important Notes

- » It is recommended that membrane overlaps should be a minimum of 20mm wide.
- » The purpose of a vapour control layer is to form a fully airtight and vapour tight layer.
- » The 0531FR Vapour & Air Tape should be installed with the printed side facing into the building. If there is any doubt about the direction of application, please speak to the OBEX technical team.
- » To meet the notional dwelling specification for a new dwelling of $5\text{m}^3/(\text{h}/\text{m}^2)$ at 50 Pa (summarised in Table 1.1 of Approved Document L), either method can be used.
- » Obex recommend ordering 0531FR with the split release liner to for easier application.
- » If bonding onto a porous surface, apply OBEX CORTEX 0787FR Non-Flammable Surface Primer to the surfaces prior to application. Allow time to flash off.

This install guide contains two methods of installation:

- » **Method A – this is for non-Passivhaus installations**
- » **Method B – this achieves Passivhaus level A**
- » **To meet the notional dwelling specification for a new dwelling of $5\text{m}^3/(\text{h}/\text{m}^2)$ at 50 Pa (summarised in Table 1.1 of Approved Document L), either method can be used.**

Installation Method A



1

Unroll a minimum of the frame width or height + 50mm for overlapping.

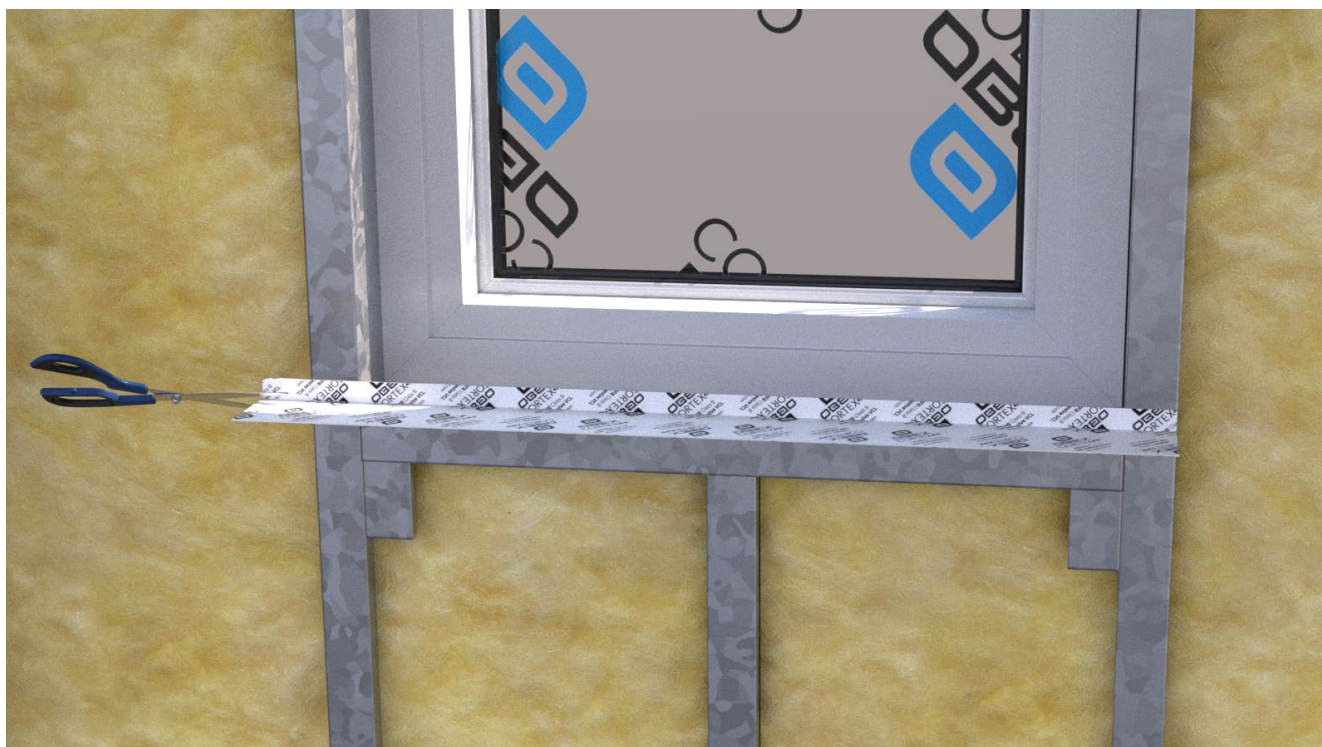

2

Cut a slit 50mm long into the ends of the membrane as shown above. A 20mm bond-width is recommended onto the window frame, so each slit should be 20mm from the edge of the membrane. The Cortex 0531FR can also be supplied with a 20mm split release liner - in these cases, the slit at each end can follow the split in the release liner.

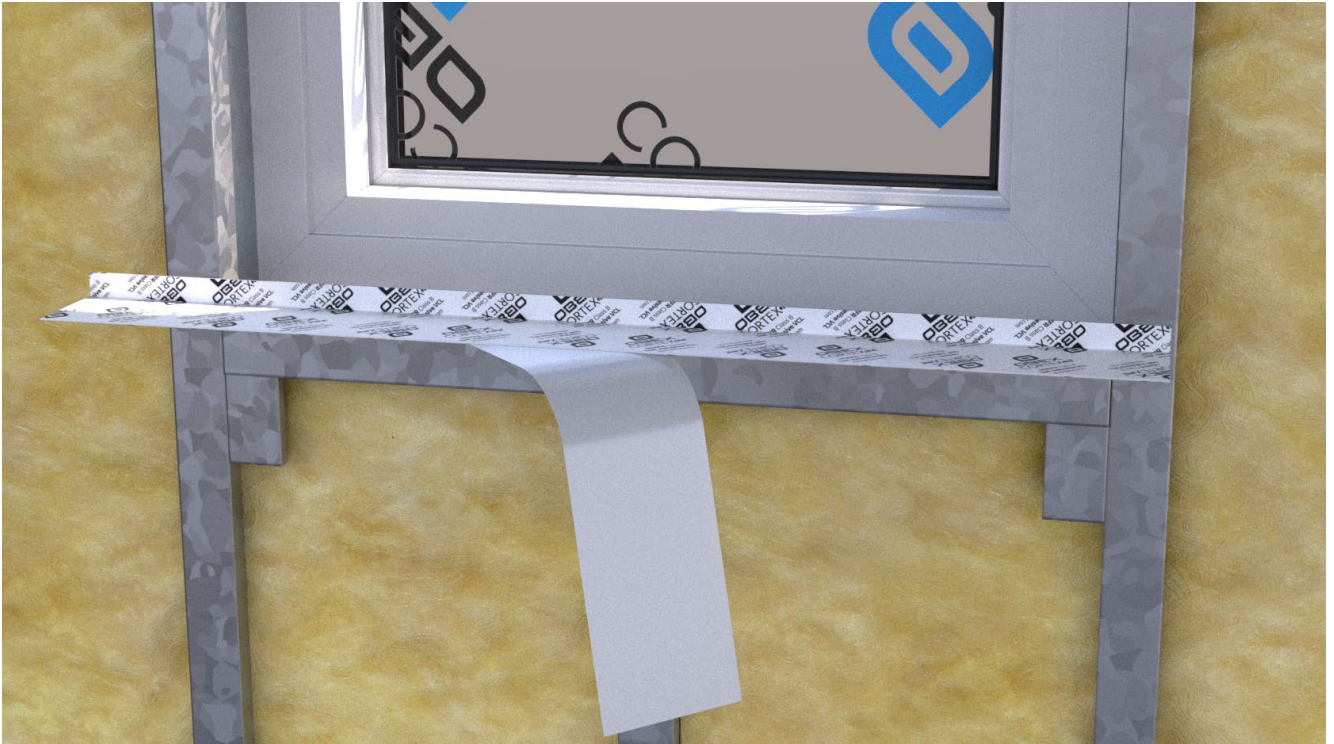

3 To aid installation, only remove the first 20mm of the release liner. Follow step 4 below for application into the reveal.



4 Starting from the sill of the window, remove the first 20mm of the release liner and bond this section to the window frame. Once positioned and fully bonded to the window frame, remove the remainder of the release liner and bond to the reveal, overlapping onto the vertical sections. Fold and lap the corners as shown in the right hand image above.

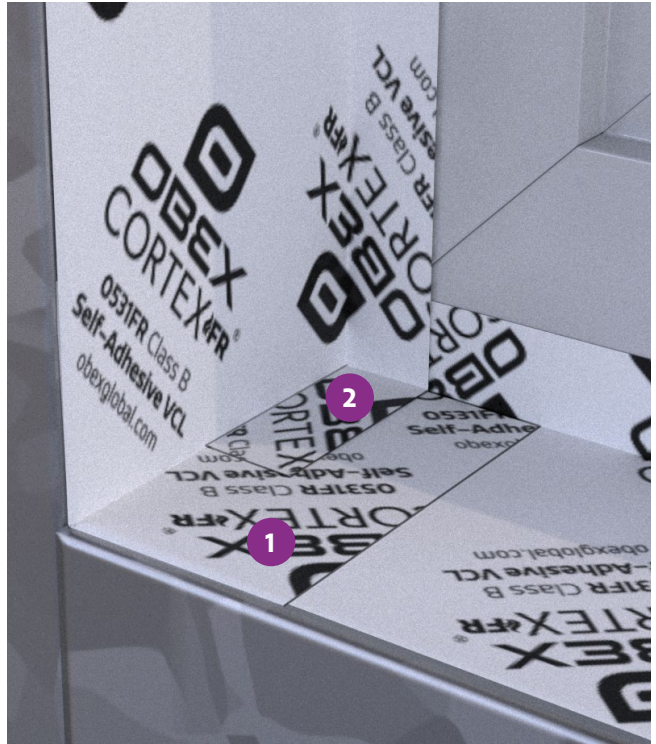
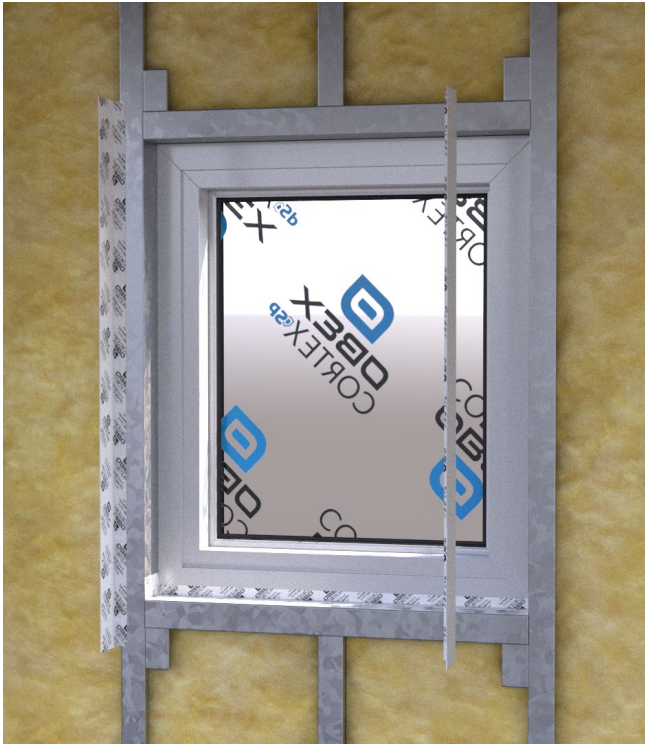

5 Repeat steps 1-4 for the sides, overlapping in the order shown in the second image.

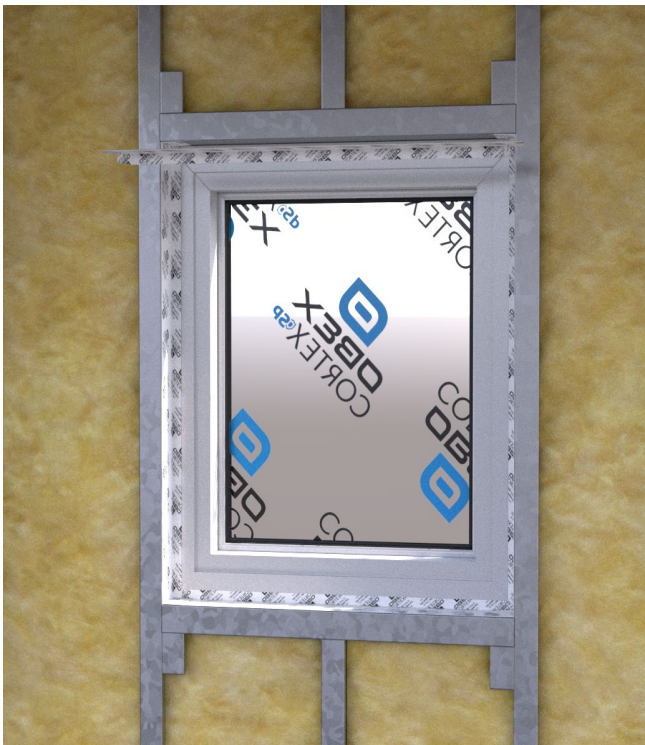

6 Repeat steps 1-4 for the top, overlapping in the order shown in the second image.



7

Use a rubber roller to ensure maximum adhesion.



8

This is how membrane should look when correctly installed.

Installation Method B - Achieves Passivhaus level A

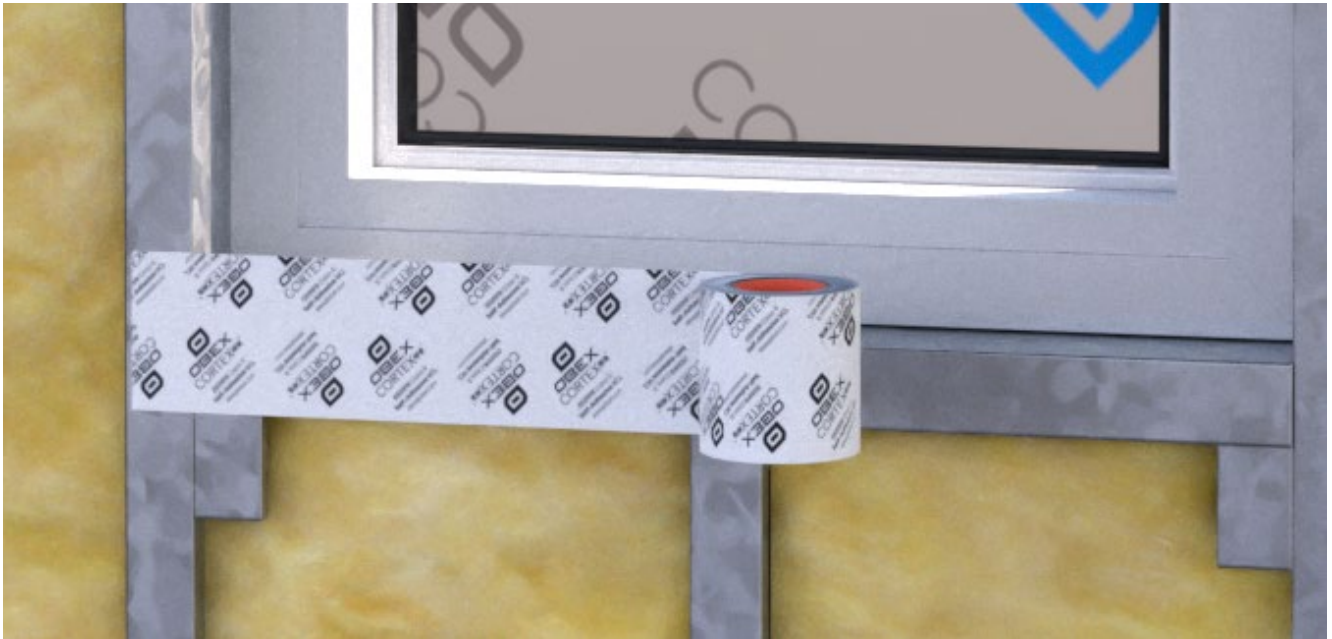

1

Unroll and cut to half the width of the opening + 20mm to allow for overlapping. To aid installation and positioning, install the 0531FR in sections at a max of 500mm long.



2

Offer up the tape into the opening and crease horizontally to allow for a 20mm bond-width onto the window frame. Folded tape should be rolled with a rubber roller to ensure a clean fold. If the tape has been supplied with a 20mm split release liner, the tape must be creased along this split.



3

Due to the rigidity of the tape, careful positioning is needed. Position the tape in place, then fold the upper section, remove the release liner and adhere. Repeat for the base section.

Please note: Creases affect airtightness. Use a rubber roller and careful positioning to avoid creases.

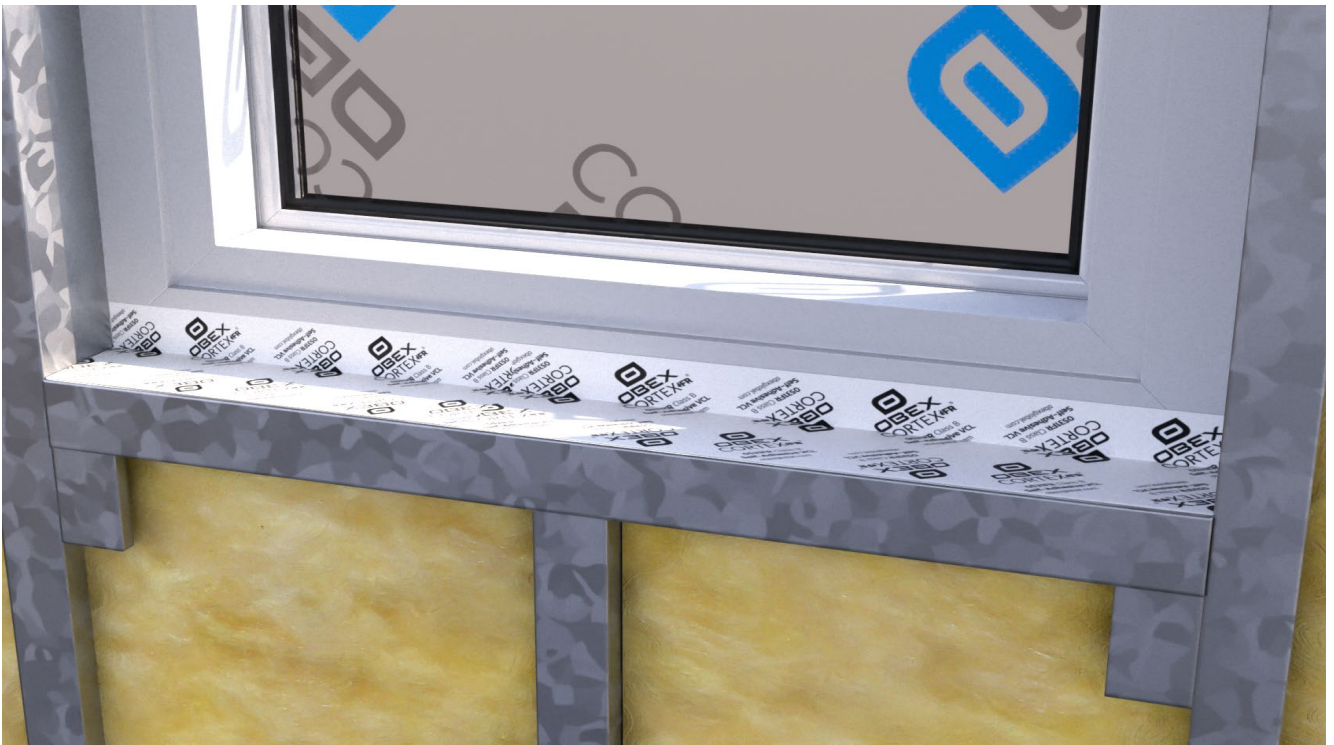

4

Repeat steps 1 - 3 for the other half of the base.



5

Repeat steps 1-4 for the rest of all sides, ensuring that the top section is sealed last.

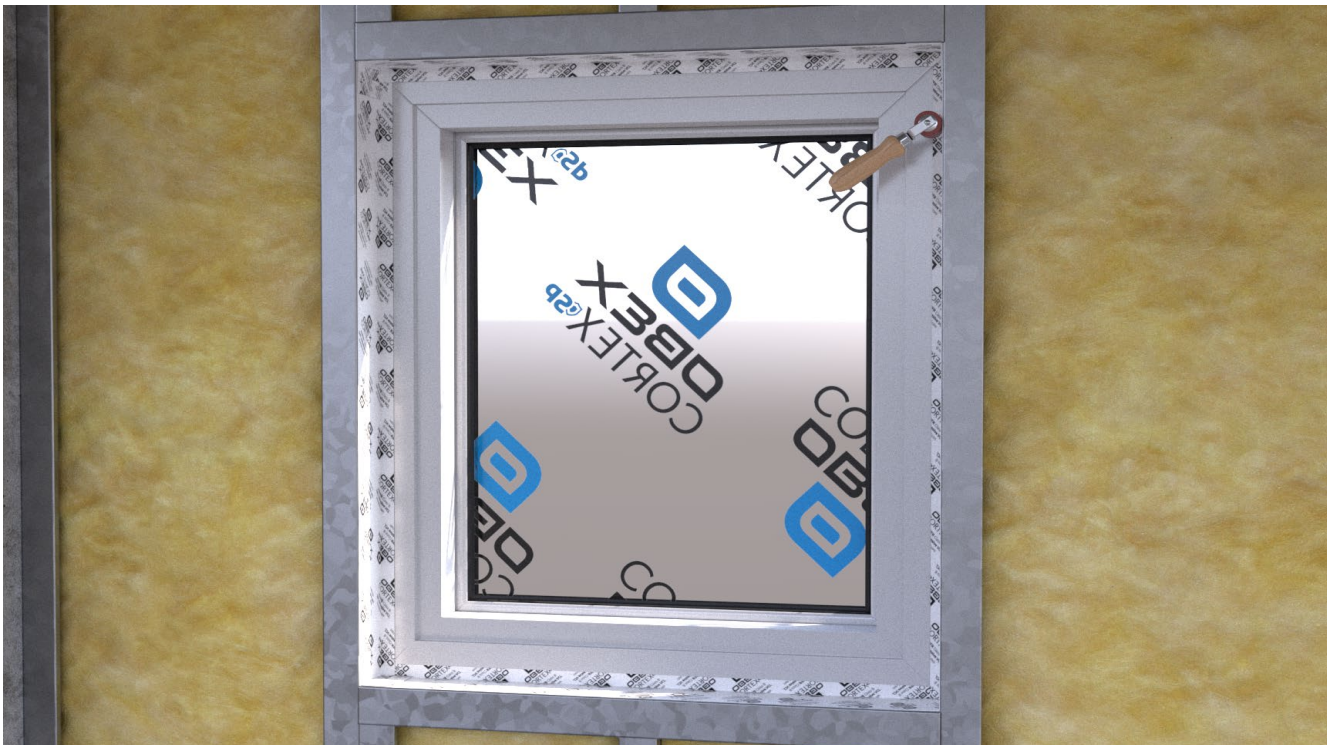

6

Use a rubber roller to ensure maximum adhesion.



The visual above shows the correct installation sequence.

7



8

Apply a bead of the Obex Cortex 0771FR Paste Adhesive at the corners, along membrane joints, including the middle of the window, as indicated in the image above. Lightly tool off the paste adhesive to finish.



9

This is how membrane should look when correctly installed.



UK
OBEX Protection Ltd.
+44 (0)1905 337 800
www.obexuk.com

AU
OBEX Group Pty Ltd.
+61 (0)248 691 932
www.obexau.com

EU
OBEX Protection France
+33 (0)4 94 65 86 14
www.obexeu.com