

 INSTALLATION GUIDE

OBEX  **CORTEX[®]**

0840

Breather Membrane

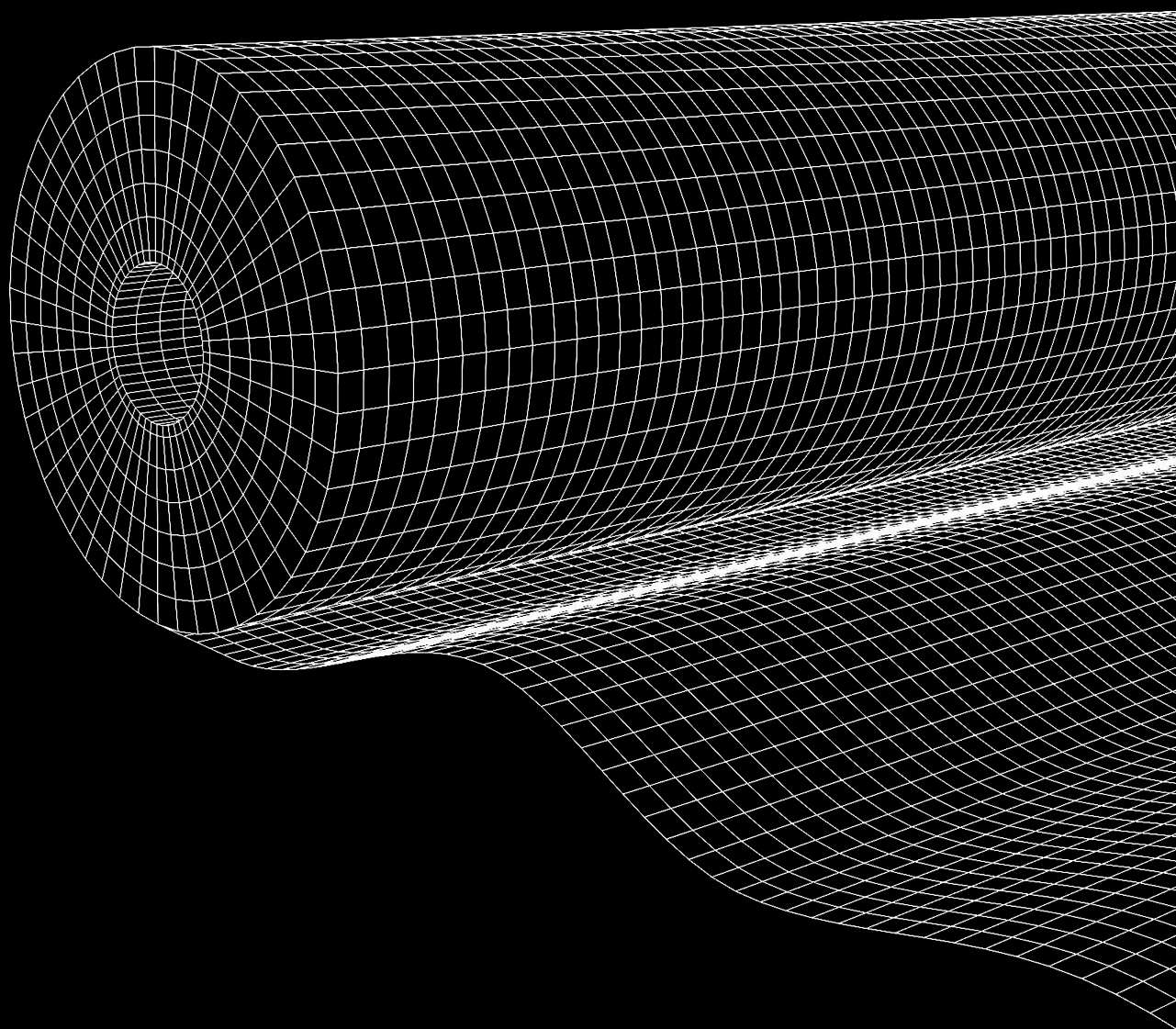

 **OBEX[®]**

VERSION: 01.01.01

Disclaimer

This installation guide is provided to enable the breather membrane to be installed independent of any other façade components. The double-sided tape is provided to hold the membrane in place before any façade brackets or ties are installed. If the bracketry or ties are installed at the same time as the breather membrane, then this can negate the requirement for double-sided tape. This should be reviewed on a project specific basis and checked by the contractor undertaking the breather membrane installation.

Important Notes

- » The membrane should be fixed in such a way as to shed water away from the sheathing board and below the lowest timber/steel frame. Upper layers should be lapped over lower layers.
- » Horizontal laps should be at least 100 mm and vertical laps 150 mm. Vertical laps should be staggered wherever possible.
- » To assist in achieving the required air permeability lap joints and penetrations through the membrane should be sealed with OBEX CORTEX 0855 Single-Sided Tape and OBEX CORTEX 0850 Double-Sided Tape.
- » When installed as per the OBEX guidelines, you should require approximately 2 rolls of OBEX CORTEX 0850 Double-Sided Tape and 6 rolls of OBEX CORTEX 0855 Single-Sided Tape.
- » Overlaps of at least 300mm should be allowed on corners.
- » It is recommend to apply an ISM (Interface Sealing Membrane) around windows, doors and the SFS infill sections before the Breather Membrane is installed.

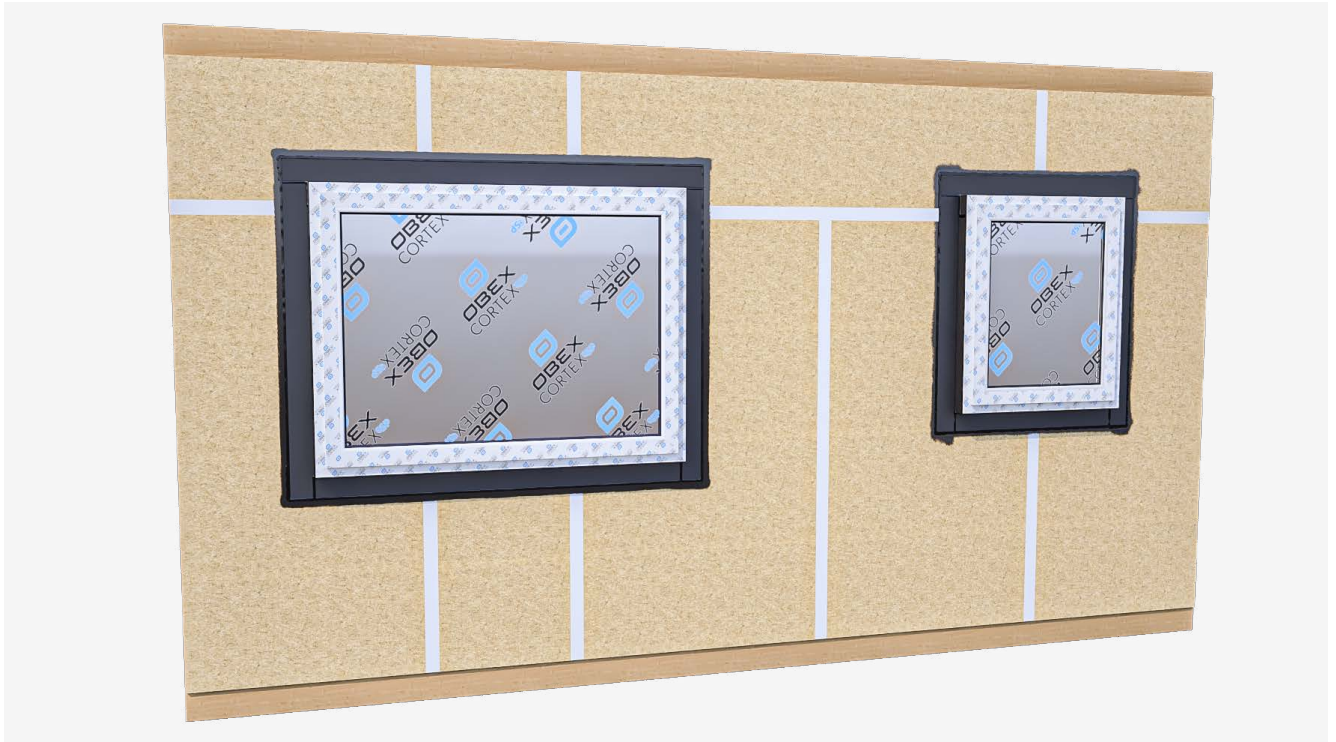

1

Install the timber studs and sheathing board as per manufactures instructions. Ensure board joints are sealed. Ensure EPDM has been installed correctly around windows & protrusions.



2

Start by applying the OBEX CORTEX 0850 Double-Sided Tape; 3 strips to cover the width of the membrane (allowance for a 100 mm horizontal lap should be made). Apply tape to ensure all edges of the membrane will be adhered e.g. where the membrane is cut around windows and other penetrations. When you are ready to start installing the breather membrane, peel off the release liner. Some may prefer to remove the release liner as they adhere the membrane.

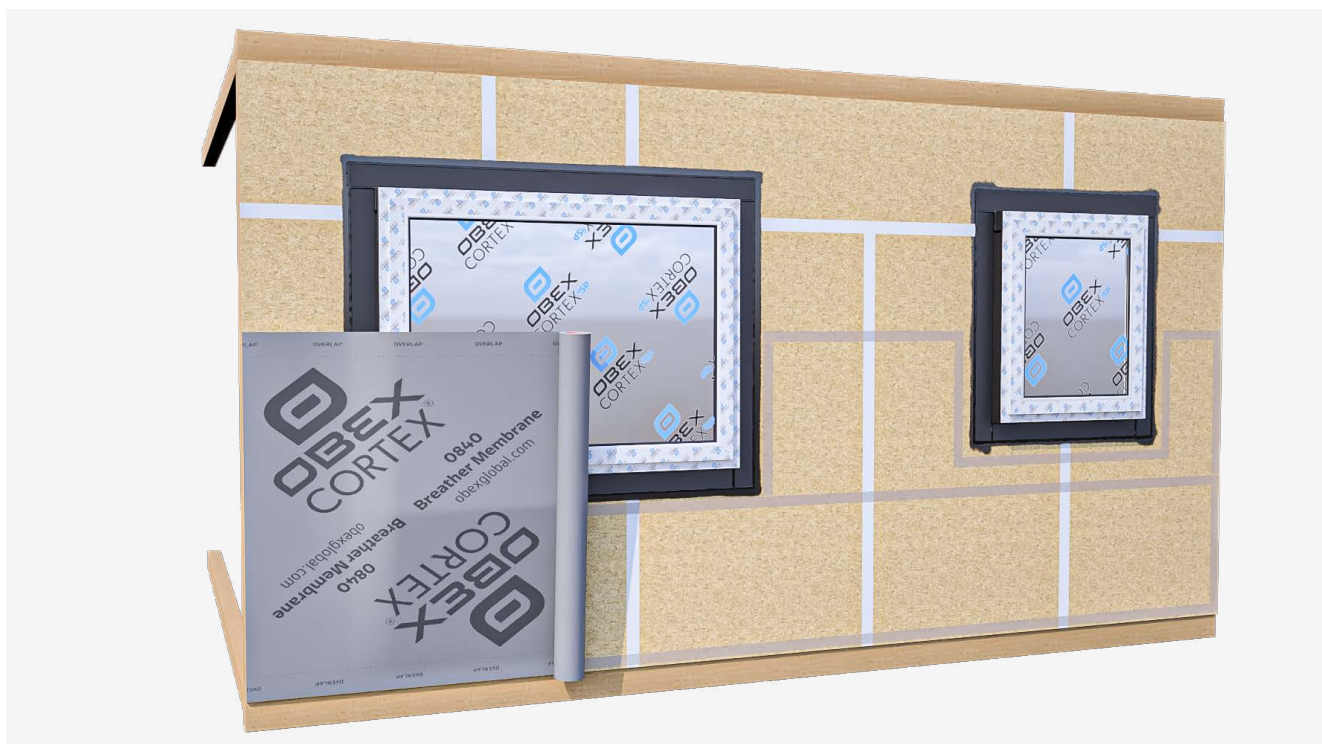

3

You're now ready to apply the breather membrane. Place the roll into position to cover the strips of double-sided tape. Where possible, the membrane should be continuous so any window/door openings or penetrations should be cut out during application, or it can be applied over the top and cut out afterwards.



4

Once a section has been finished cut flush with a utility knife.



5

Cut around any penetrations, ensuring that the Breather Membrane overlaps the ISM. Ensure to cut 30-40mm from the penetration so that there is room to apply OBEX CORTEX 0855 Single-Sided Tape at a later stage.

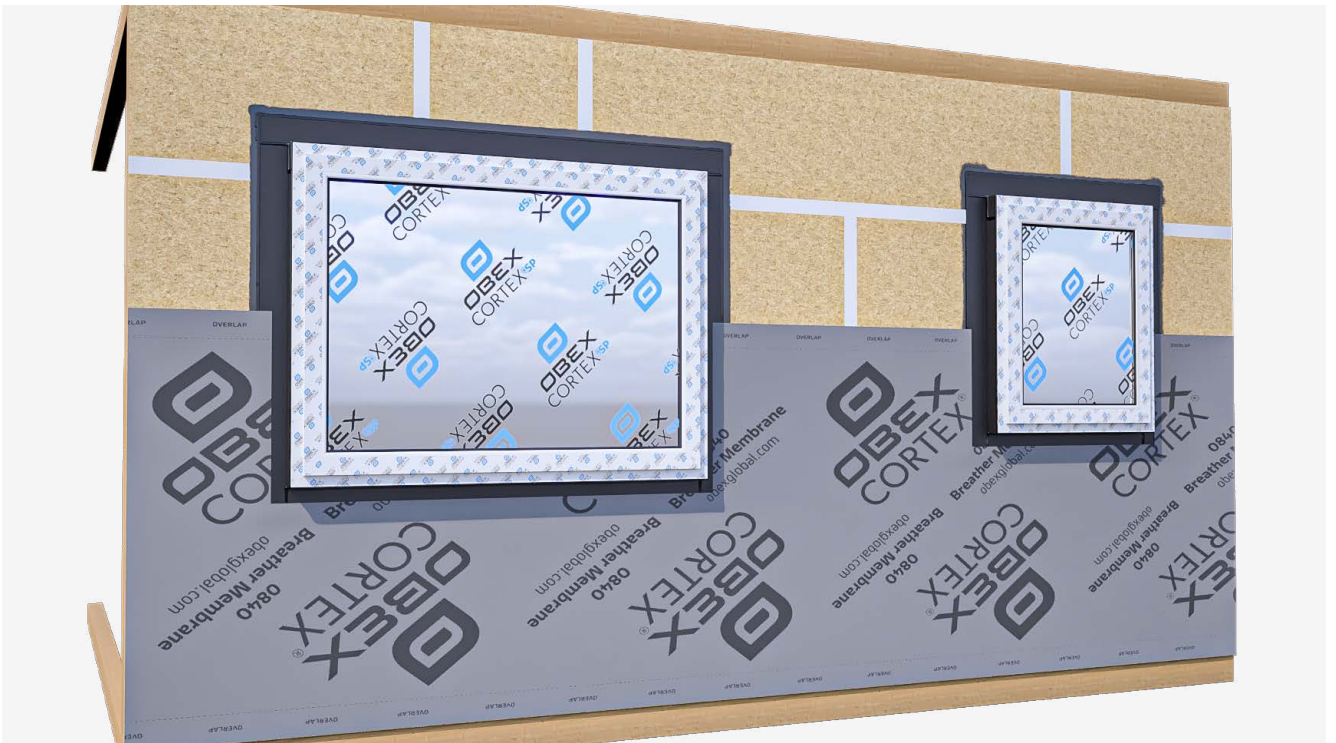

6

Ensure the membrane is adhered to the double sided tape and is smooth and flush without any creases where possible.

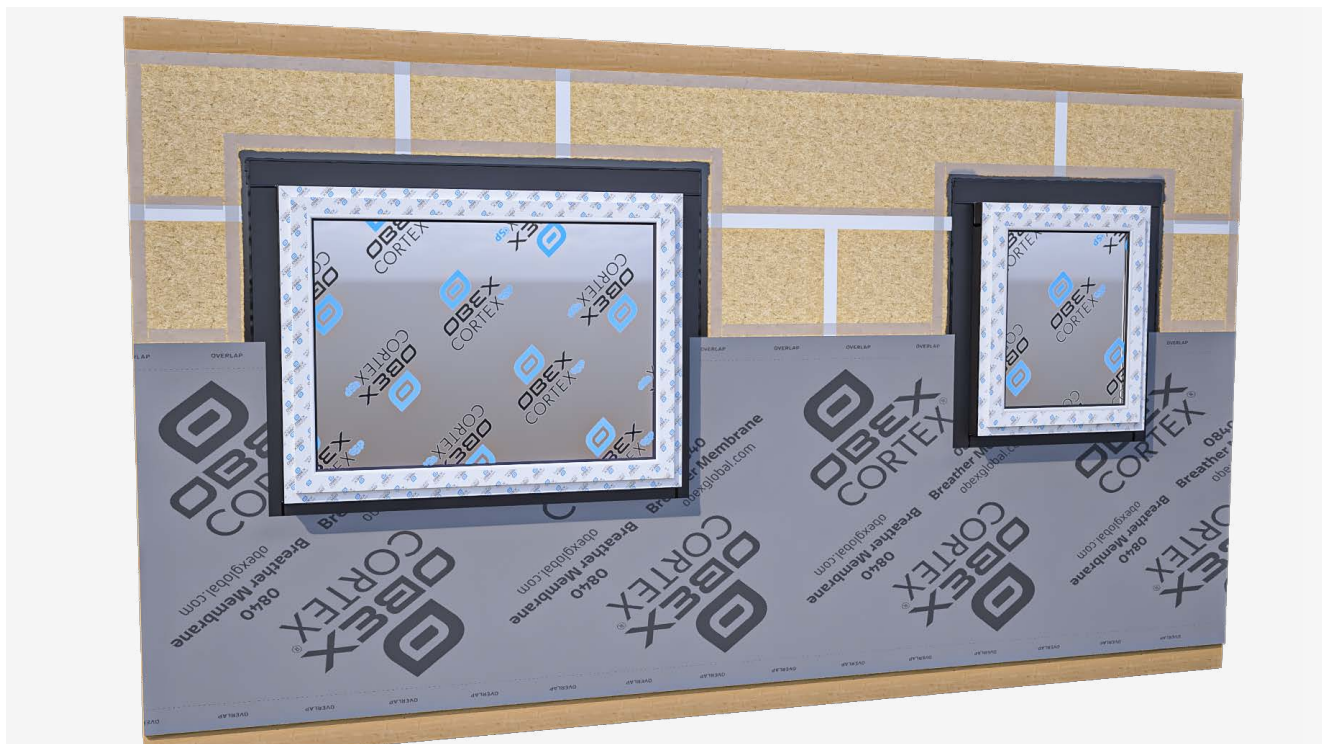

7

Apply OBEX CORTEX 0850 Double Sided Tape to the next section as per instructions in step 2.

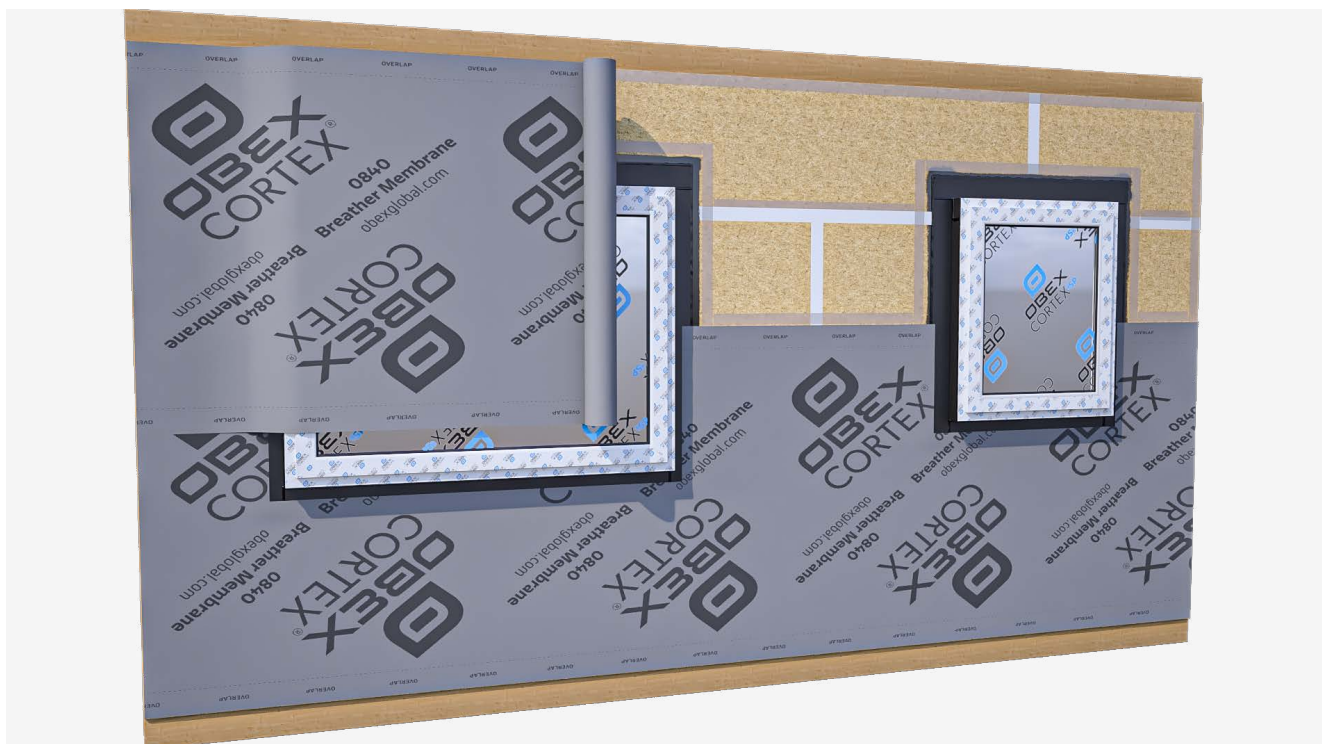

8

Roll out the next layer of OBEX CORTEX 0840 Breather Membrane, as per steps 3 - 6. Ensure an overlap of at least 100mm.

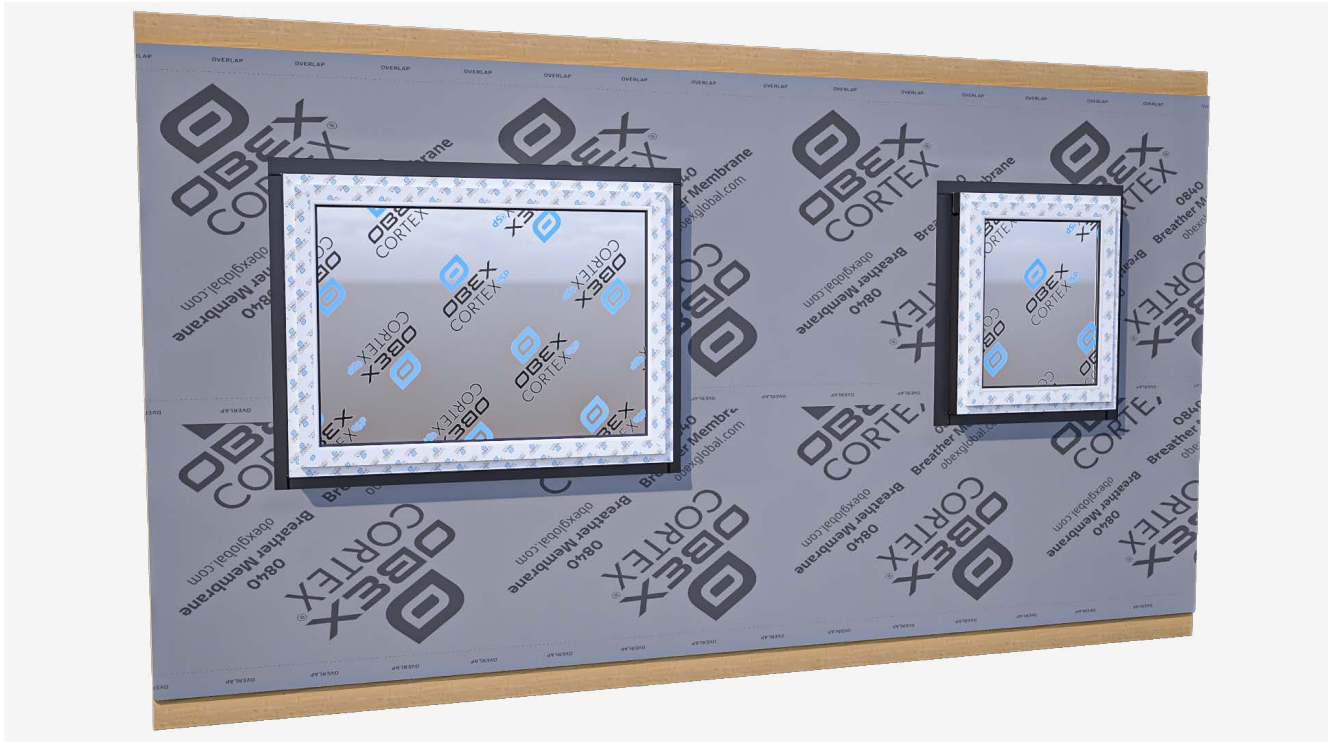

9

This is how a the wall should look with correct overlapping and window cutouts.

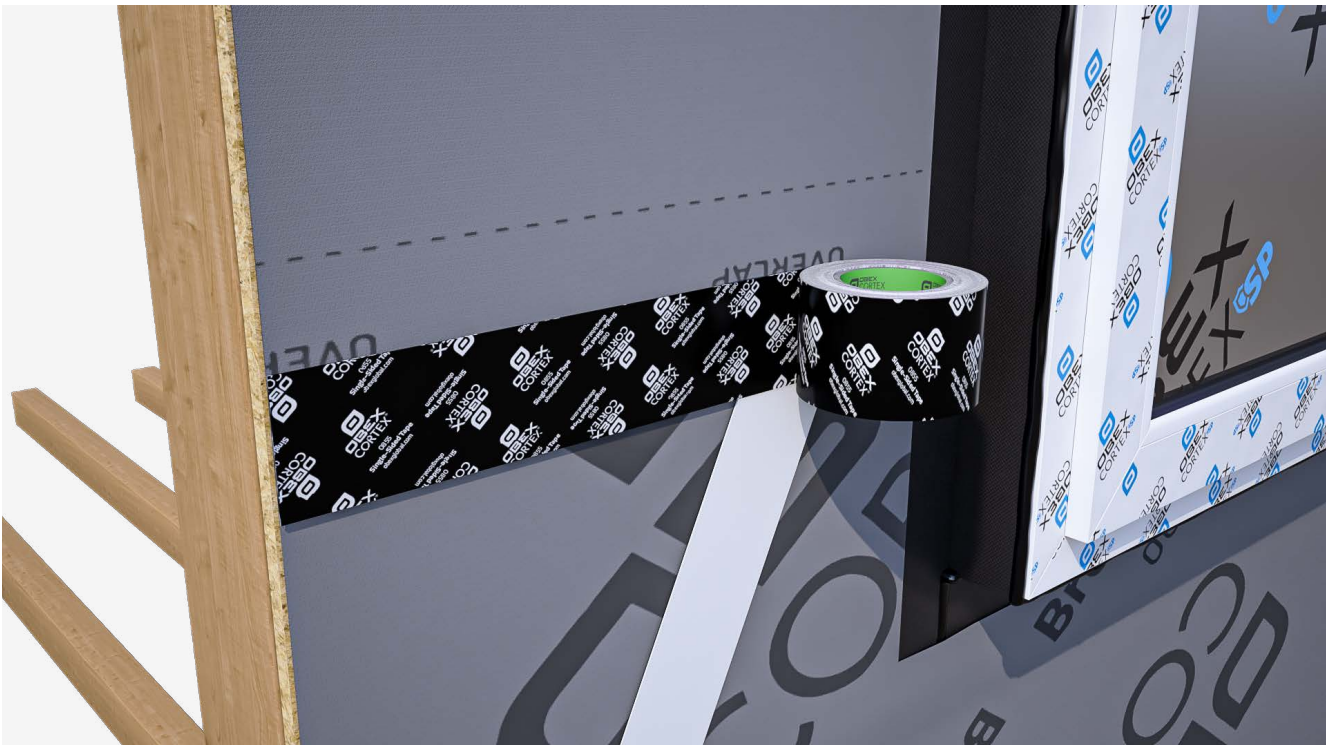

10

Seal the overlap joints with OBEX CORTEX 0855 Single-Sided Tape. Apply the tape, peeling off the release liner as it is rolled out, and apply firm pressure to ensure strong adhesion.

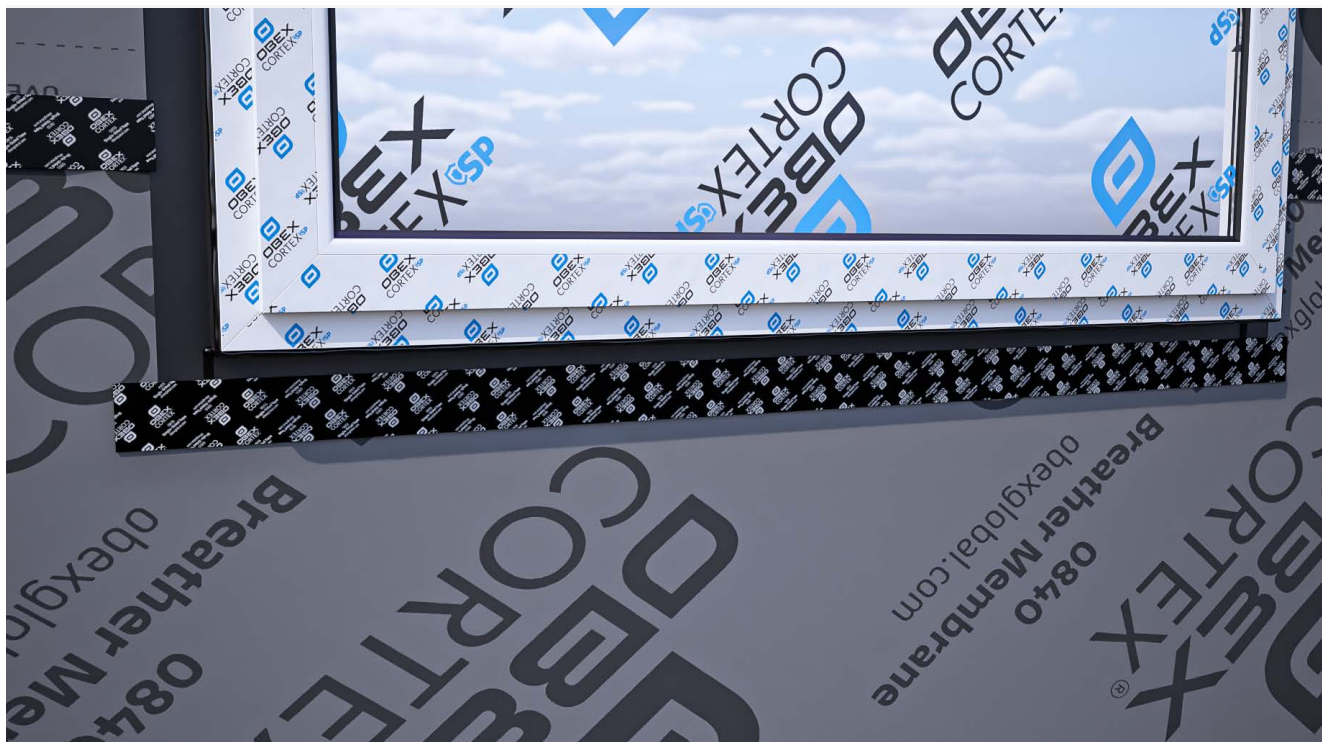

11

Next seal around the windows starting from the bottom and work upwards. Apply a layer of 0855 to the joint below the window, sealing between the breather membrane and the EPDM.



12

Next repeat step 11 for the sides, and then lastly the top joint to ensure a weather-tight seal.

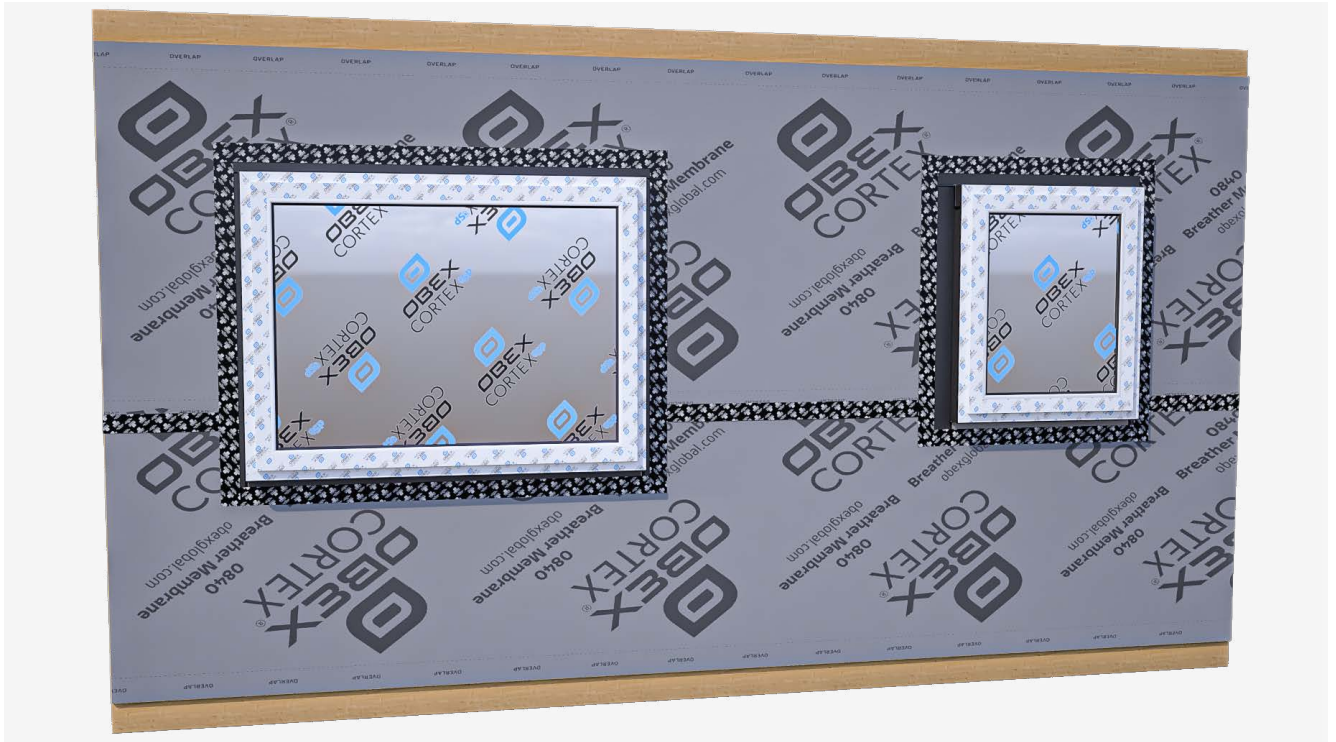

13

This is how the wall should look once the system has been installed correctly.



OBEX Protection Ltd. Unit 5 St. Modwen Park, Norton Road, Broomhall, Worcester, WR5 2QR

Call: +44 (0) 1905 337800 | **Email:** sales-uk@obexglobal.com | **Visit:** www.obexglobal.com

© Copyright 2024 OBEX. All rights reserved. Company Registration No. 09157067, VAT No: 868 7649 48