



HOW TO INSTALL...

Cortex 0901 External EPDM Corner

www.obexuk.com



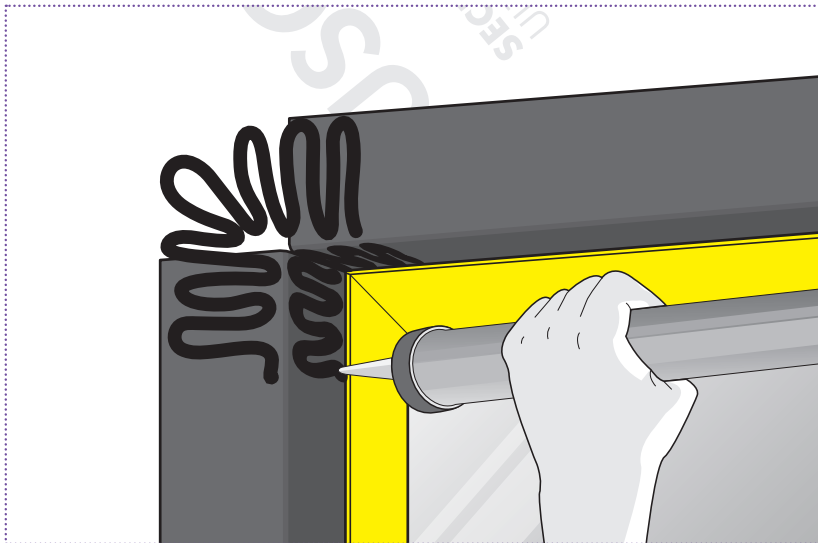

Apply Cortex Paste Adhesive 100mm width around the corner of the window.
Please note: the corner is to be installed over the top of the EPDM bonded to the Head, Jambs and the Cill.

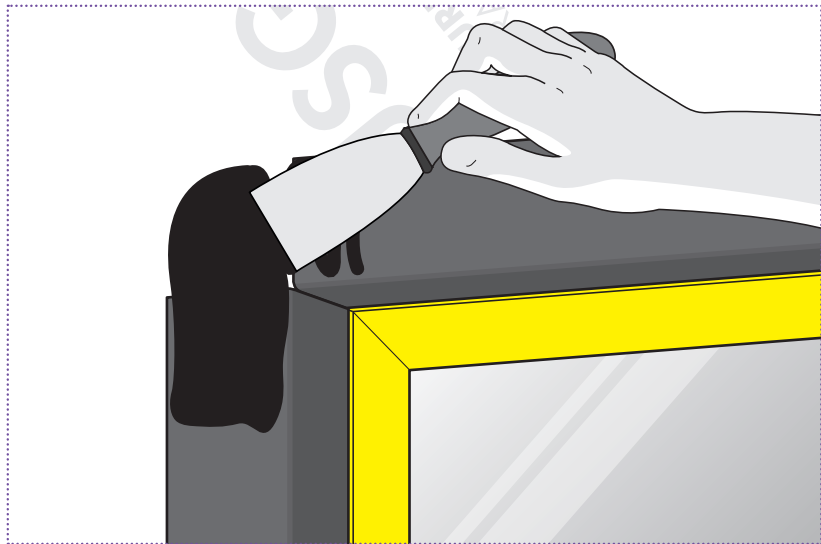

Spread out the paste adhesive to ensure a full area coverage of where the corner will be bonded using a paste adhesive spreader.

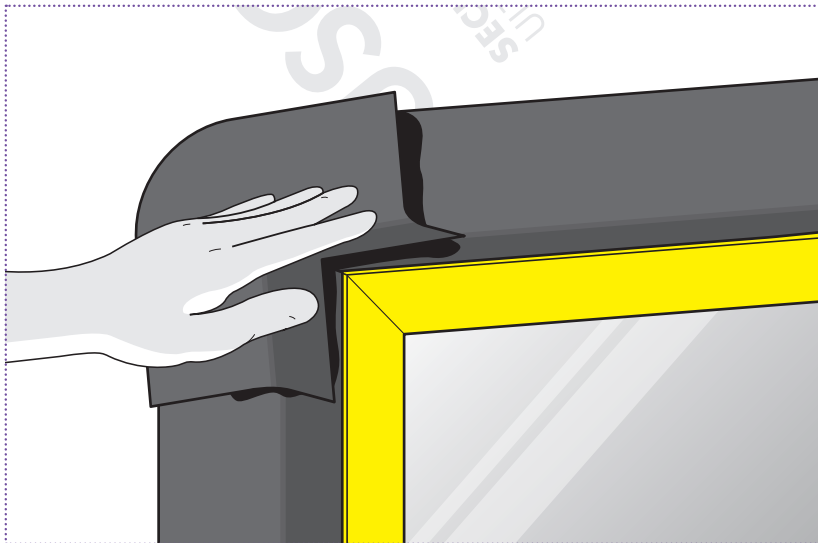

Place the Cortex 0901 EPDM Corner onto the corner of the window frame.

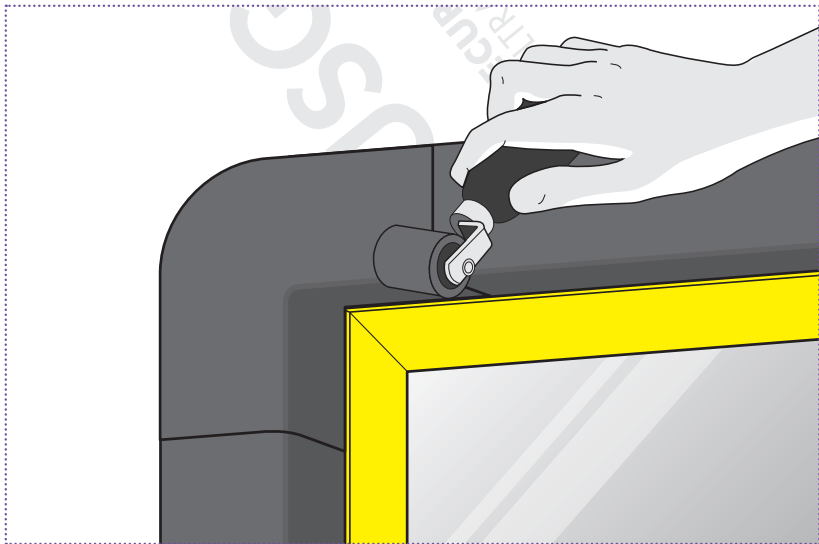

Roll firmly with a seam roller to ensure maximum bond.

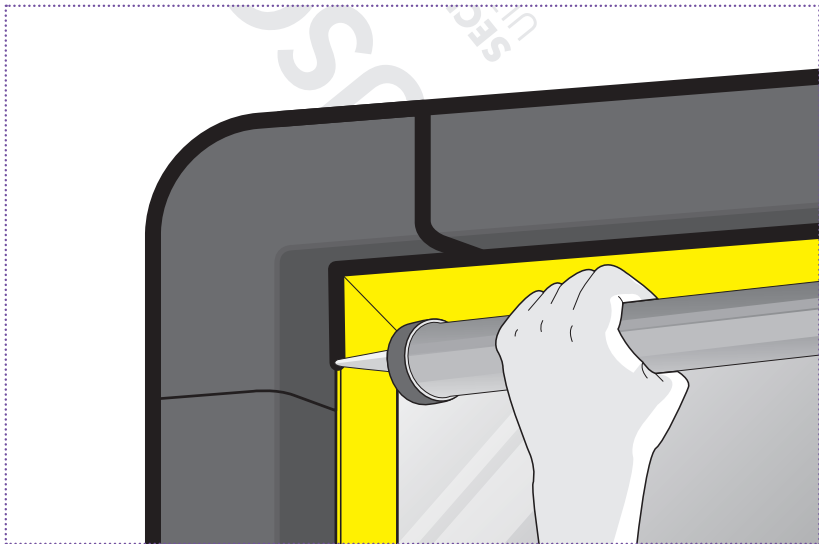

Apply Cortex Paste Adhesive around the edges of the corner with one bead of paste adhesive.

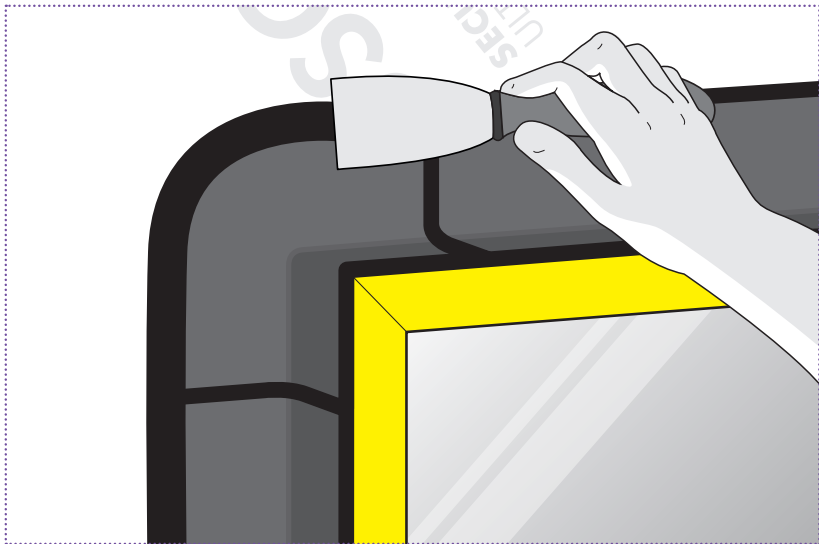

Tool off the paste adhesive with a spreader to ensure no open edges.

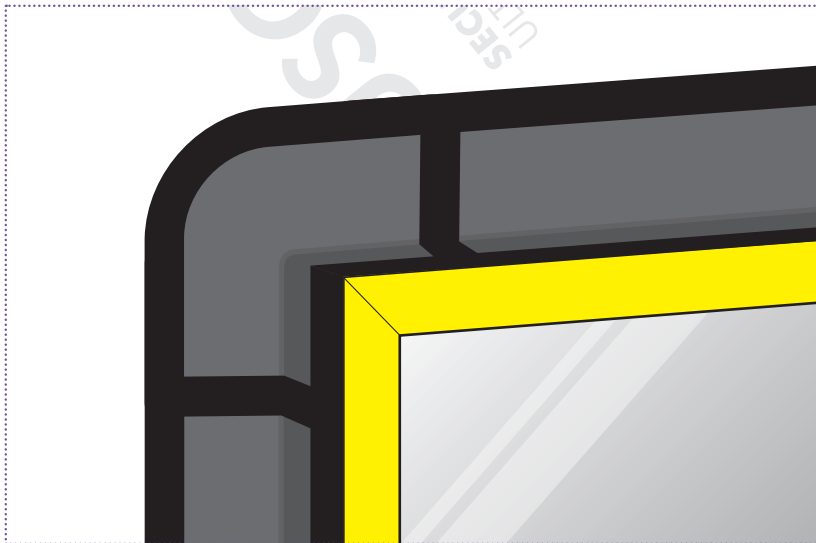

Finished corner installed and sealed with Cortex Paste Adhesive.



For technical assistance call **01905 337800**, email **sales@obexuk.com**
or visit **www.obexuk.com**