

# OBEX

## How to Install...

# Cortex EPDM Membranes



[www.obexuk.com](http://www.obexuk.com)

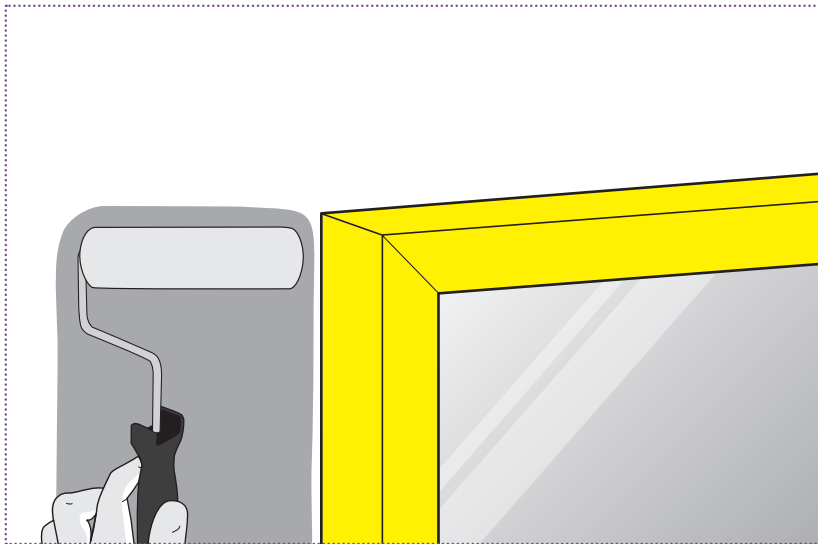

Ensure both substrates are clean, dry, and free from grease and oil prior to application. Porous surfaces may need to be primed using Cortex 0785 Primer.

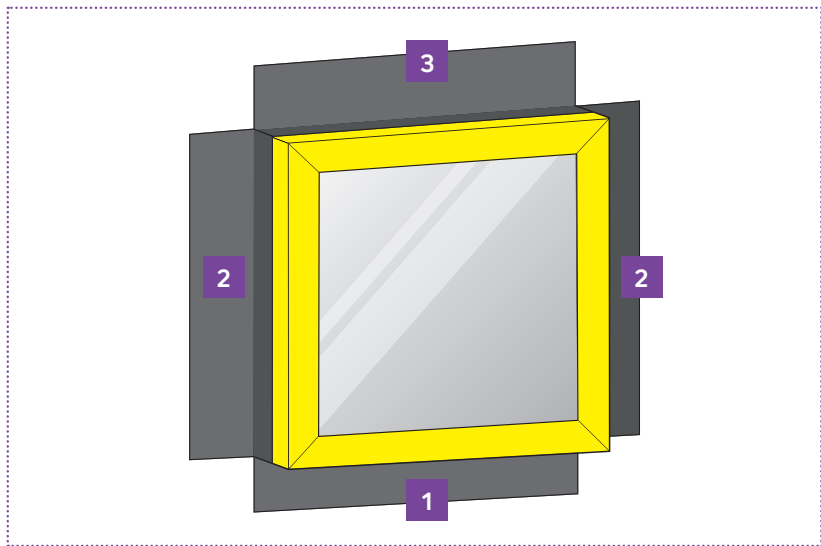

2

Cortex EPDM Membrane should be fitted in this order around the window: cill, jambs and then head.

3

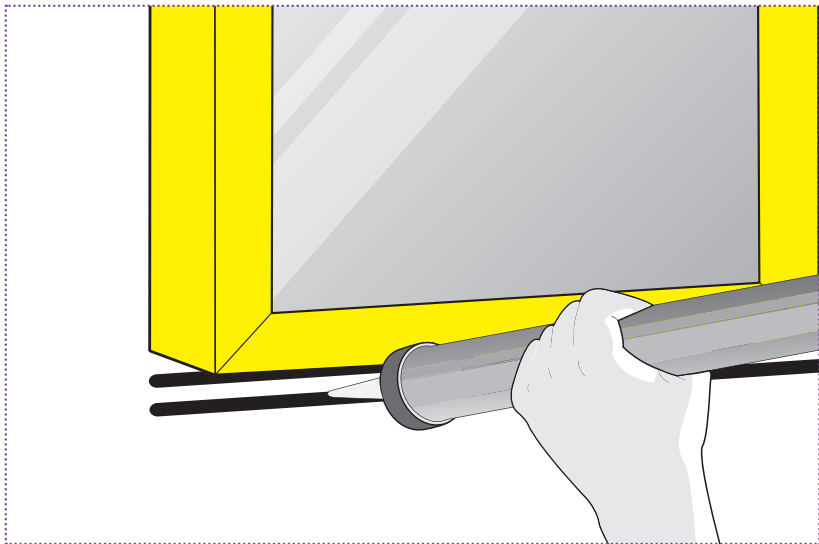

Apply Cortex Paste Adhesive to both the frame and the substrate using a paste adhesive gun.

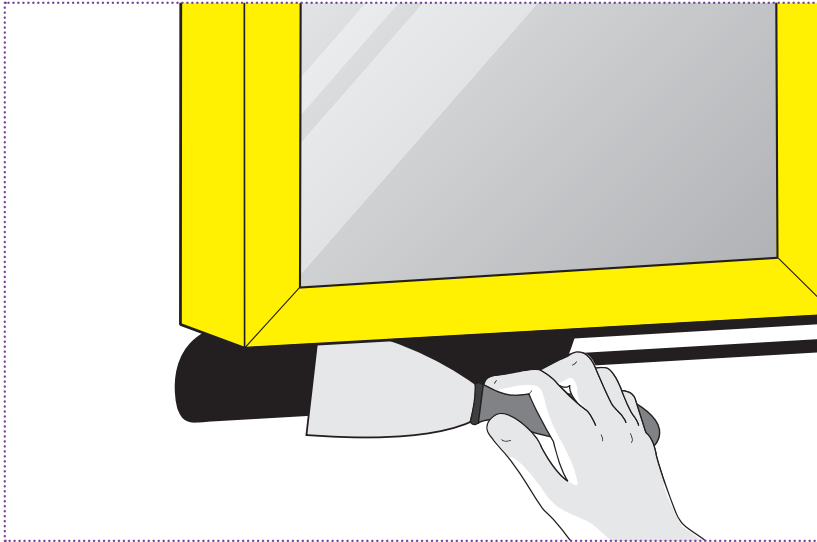

Spread out the paste adhesive using a paste adhesive spreader.

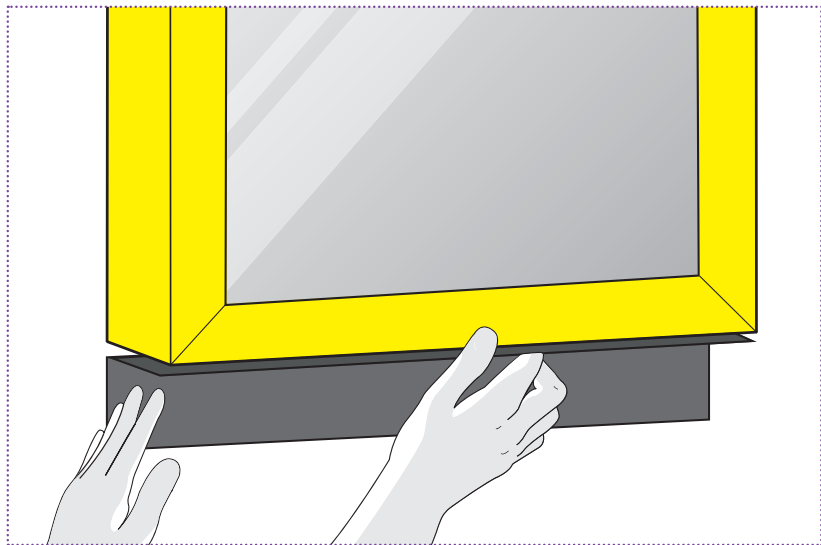

Bond the Cortex EPDM Membrane to the frame first, and then bond back to the substrate, ensuring the membrane is applied flat without creases.

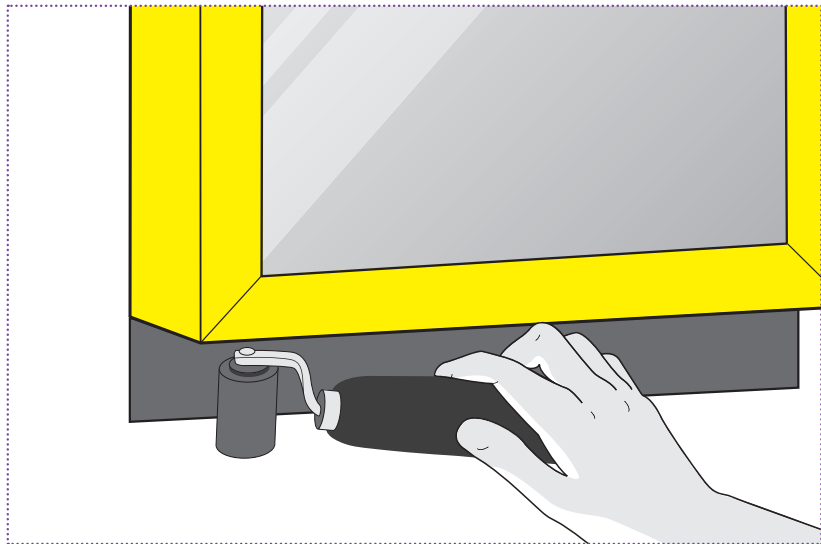

Roll firmly with a seam roller to ensure maximum bond strength on all surfaces.

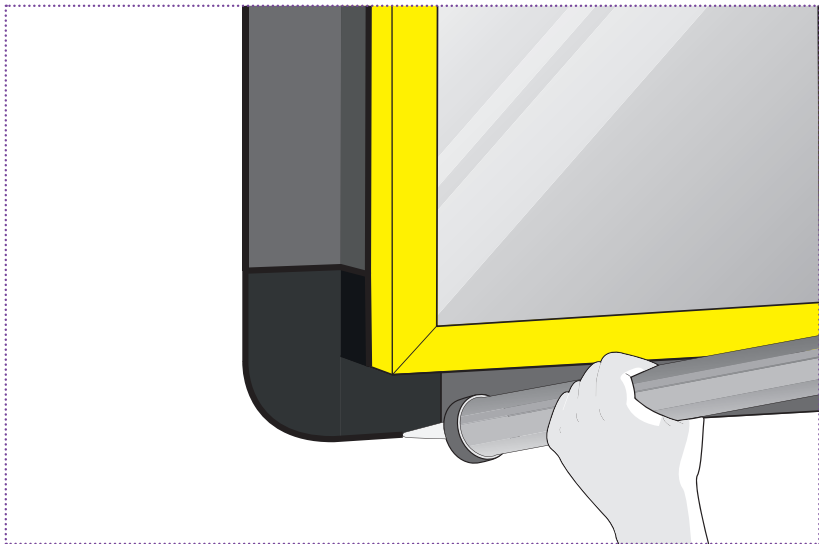

Corners can be sealed using Cortex 0901 External Corners. Apply a further bead of Cortex Paste Adhesive around the perimeter of the membrane and any joints/laps.



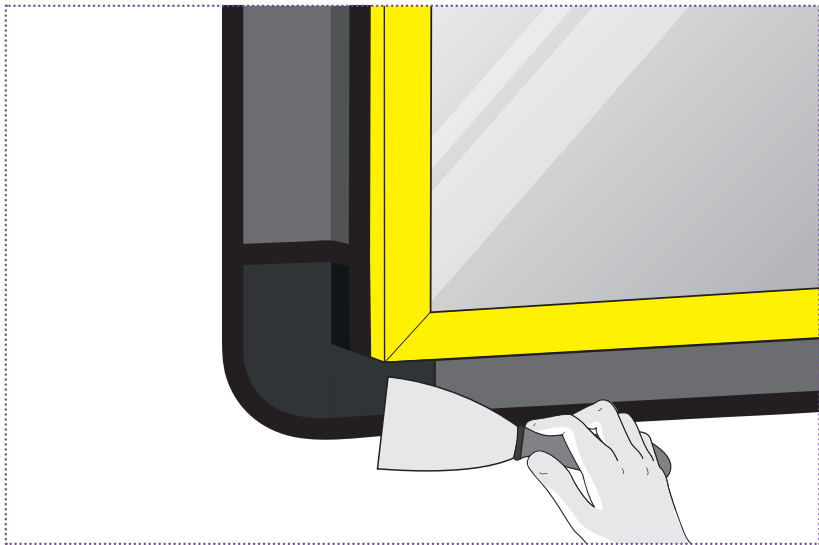

Tool off the paste adhesive with a spreader to ensure no open edges.



Once finished, the system should look similar to the above.

## Tips

- » The width of the membrane must be designed with full consideration of the facade or window detail including the interior and exterior sides of the connection joint.
- » The recommended overlap between membranes and porous materials (concrete, brick) is a minimum 100mm. For non-porous material, we recommend at least a 20-30mm bond width.
- » Porous surfaces may need to be primed using Cortex 0785 Primer.
- » Cortex 0901 Corners can be used to provide a 100% watertight seal at corner junctions.

# OBEX

---

**CORTEX**  
EPDM membrane system



For technical assistance, call **01905 337800**,  
email **[sales@obexuk.com](mailto:sales@obexuk.com)** or visit **[www.obexuk.com](http://www.obexuk.com)**